

## PRESSURE GAUGES AND GAUGE BLOCKS 700 - 1000 - 3000 - 4000 BAR

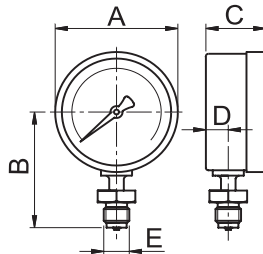

- Max Working pressure **700 - 4000 bar**
- Dial diameter **63 - 100 mm**
- Accuracy of full scale **1% - 1,6%**
- Scale **bar - bar/kN**

### SELECTION CHART FOR DOUBLE SCALE GAUGES

MODEL	Scale bar	Scale kN	For cylinders	Dimensions
G10F1020	700	0-121 / 0-225	CMF 10/20 ton	See G10 chart
G10F3060		0-327 / 0-578	CMF/COF 30/60 ton	
G10S1020		0-109 / 0-194	CGS/CMC/CMI/CMP/COI 10 ton	
G10S2530		0-228 / 0-303	CGS/CMC/CMP 20 ton	
G10S50100		0-486 / 0-911	CMI 25 ton - CGG/CGS/CMC/CMI/CMP/COI 30 ton	
			CGG/CGS/CMC/CMI/CML/CMP/COI/COS 50/100 ton	

### FEATURES

#### Pressure Gauges

Available with 63 or 100 mm dial with read-out in bar and PSI. The 1000 bar gauges are glycerine filled while the 1600, 3000, 4000 bar are dry.

The G106L pressure gauge has a 1/4" NPT screwed connection at 3 o'clock for direct installation on the left side of the pump head.

The model G10 exists also in the double scale version, bar and kN, to be used up to 700 bar, different for cylinders with hollow piston (G10F##) and for cylinders with normal piston (G10S##).

#### Gauge blocks

Manufactured in steel and available in four versions to suit the gauge diameter and distance from the equipment.

### PRESSURE GAUGE SELECTION CHART: 700 - 1000 BAR

Max Working Pressure	Full scale	Dial diameter	Precision class DIN16005	Scale indexing	Thread	MODEL	Dimensions mm				Weight
							A	B	C	D	
bar	bar	mm	%	bar	E					kg	
700	1000	63	1,6	50	1/4" NPT	G106L G106	68	54	32	13	0,2
1000	1000	100	1,0	20	1/2" BSP Swivel	G10	101	98	49	15,5	0,8

### PRESSURE GAUGE SELECTION CHART: 1600 - 3000 - 4000 BAR

Max Working Pressure	Full scale	Dial diameter	Pressure Class DIN16005	Scale indexing	Thread	MODEL	Dimensions mm				Weight
							A	B	C	D	
bar	bar	mm	%	bar	E					kg	
1600	1600	100	1,0	50	1/2" BSP *	G16 G30 G40	101	98	49	15,5	0,6
3000	3000				1/2" BSP **						
4000	4000				M16x1,5 Female						

\* Swivelling \*\* Fixed



Digital gauges can be supplied on request.

### SELECTION CHART FOR 1000 BAR GAUGE BLOCKS TO BE MOUNTED IN-LINE

MODEL	Max working pressure	Gauge connection	In/out connection	A Dimension	Weight
	bar				
RP52	1000	1/4" NPT	3/8" NPT	100	0,40
RP50				60	0,28
RP501		1/2" BSP		90	0,33
RP502				140	0,42



Adapters range for gauges 1000, 1600, 3000 bar

p. 51

