

**CRI**

10-500 ton
Stroke 160-330 mm
700 bar

CRI
Series

Cylinders with oil return



- With the oil return system strokes can be longer than in cylinders with a spring return. Thanks to the oil return system, return times are shorter under all operating conditions.
- Suitable for push installing underpasses or for tests on foundation piles.
- With the threaded body cylinder, positioning is easier, more accurate and safer.
- The stop ring not only guarantees maximum operator safety, preventing plunger over-stroke, but also outstand eccentric load absorption.
- The wiper reduces contamination between ring and rod.
- High-strength, splined removable head.
- Models weighing more than 20 kg are equipped with a handle or lifting eyebolts to make them easier to carry.

**SPECIAL CYLINDERS
ON REQUEST**



Push cylinders to move decks for building renovation operations.

400-ton CRI cylinder and hydraulic pump for load tests on reinforced concrete structures.

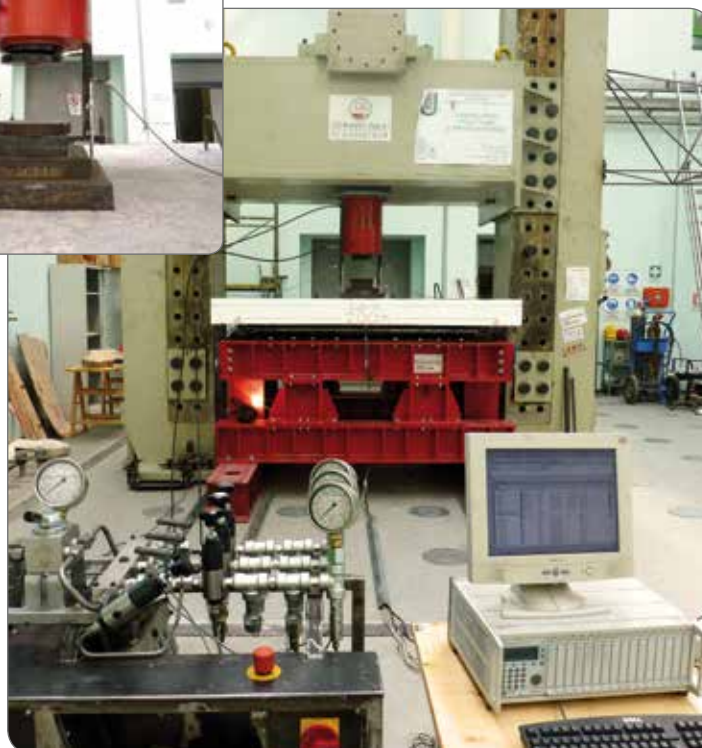
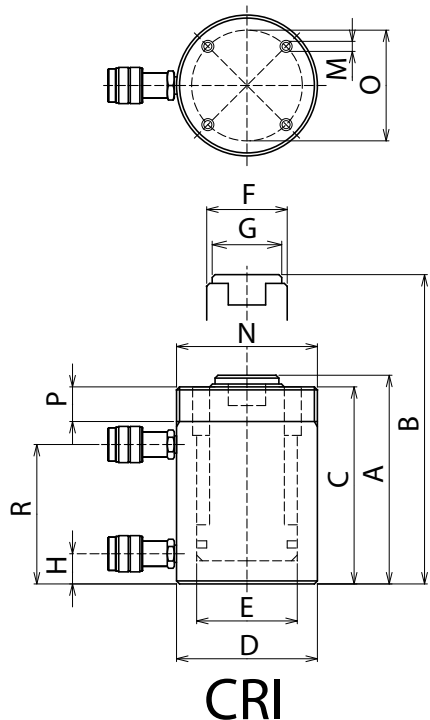

CAP ton	STROKE mm	MODEL	FORCE max kN		SECTION cm ²		VOLUME cm ³		WEIGHT kg	DIMENSIONS in mm												
			Push	Pull	Push	Pull	Push	Pull		A	B	C	D	E	F	G	H	M	N	O	P	R
10	160	CRI-10/160	111.3	16	15.9	4.6	254.5	73	5	250	410	242	60	45	38	37	20	2xM8	M60x1.5	22	32	190
	260	CRI-10/260	111.3	16	15.9	4.6	413.5	118.6	6.8	350	610	342	60	45	38	37	20	2xM8	M60x1.5	22	32	290
30	160	CRI-30/160	309.3	55.7	44.2	15.9	706.9	254.5	20.9	292	452	280	113	75	60	58	32	2xM10	M112x2	50	35	223
	260	CRI-30/260	309.3	55.7	44.2	15.9	1148.6	413.5	27.5	392	652	380	113	75	60	58	32	2xM10	M112x2	50	35	323
50	160	CRI-50/160	549.8	99	78.5	28.3	1256.6	452.4	33.8	310	470	298	140	100	80	79	32	4xM12	M140x3	70	45	233
	330	CRI-50/330	549.8	99	78.5	28.3	2591.8	933.1	53.3	503	833	495	140	100	80	79	32	4xM12	M140x3	70	45	438
75	160	CRI-75/160	791.7	121	113.1	34.6	1809.6	552.9	57.4	324	484	312	175	120	100	96	32	4xM12	M175x3	85	48	242
	260	CRI-75/260	791.7	121	113.1	34.6	2940.5	898.5	73.6	424	684	412	175	120	100	96	32	4xM12	M175x3	85	48	342
100	160	CRI-100/160	1077.6	156	153.9	44.6	2463	713.3	67.2	328	488	313	190	140	118	108	38	4xM12	M190x4	100	40	254
	330	CRI-100/330	1077.6	156	153.9	44.6	5080	1471.1	102.4	515	845	498	190	140	118	108	38	4xM12	M190x4	100	55	424
150	160	CRI-150/160	1496.8	283.8	213.8	81.1	3421.2	1297.5	99.7	353	513	338	225	165	130	126	43	4xM12	M225x4	120	48	270
	330	CRI-150/330	1496.8	283.8	213.8	81.1	7056.2	2676	149.7	548	878	533	225	165	130	126	43	4xM12	M225x4	120	55	440
200	160	CRI-200/160	1984.7	373.8	283.5	106.8	4536.5	1709	122.8	360	520	345	258	190	150	146	46	4xM12	M255x4	140	48	277
	330	CRI-200/330	1984.7	373.8	283.5	106.8	9356.4	3524.9	182.3	555	885	540	258	190	150	146	46	4xM12	M255x4	140	60	447
300	160	CRI-300/160	2908.3	563.5	415.5	161	6647.6	2576.1	185.2	352	512	335	308	230	180	176	52	4xM16	M305x4	200	55	245
	330	CRI-300/330	2908.3	563.5	415.5	161	13710.7	5313.2	277.5	547	877	530	308	230	180	176	52	4xM16	M305x4	200	65	430
400	160	CRI-400/160	4007.9	791.7	572.6	226.2	9160.9	3619.1	286.5	378	538	360	368	270	210	206	67	4xM16	M365x4	250	60	275
	330	CRI-400/330	4007.9	791.7	572.6	226.2	18894.3	7464.4	422.9	578	908	560	368	270	210	206	67	4xM16	M365x4	250	70	460
500	160	CRI-500/160	4948	1019.8	706.9	291.4	11309.7	4662.1	370.6	390	550	370	412	300	230	226	73	4xM16	M410x4	280	65	280
	330	CRI-500/330	4948	1019.8	706.9	291.4	23326.3	9615.6	540.6	590	920	570	412	300	230	226	73	4xM16	M410x4	280	80	465

Cylinders with higher tonnage and different strokes are also available.