

HYDRAPAC ITALIA S.r.l. s.u. HYDRAULIC COMPONENTS

Vicolo Del Lavoro, 9 40069 Zola Predosa (Bologna) Italia
tel. +39 051 755082 fax: +39 051 6185568 e-mail: italia@hydrapac.it

www.hydrapac.it

staffe e collari per fissare tubi
clamps for all clamping applications



Staffe e collari per fissare tubi

Clamps for all clamping applications

SOMMARIO • INDEX

| | |
|---|----|
| Introduzione <i>Introduction</i> | 2 |
| Suggerimenti per il montaggio <i>Mounting details</i> | 4 |
| Programma di produzione <i>Production program</i> | 6 |
| Collari serie standard in polipropilene, poliammide autoestinguente, gomma o alluminio <i>Standard clamps in polypropylene, self-extinguishing polyamide, rubber or aluminium</i> | 7 |
| Collari serie standard con piastra superiore in polipropilene, poliammide autoestinguente, gomma o alluminio <i>Standard clamps with upper plate in polypropylene, self-extinguishing polyamide, rubber or aluminium</i> | 10 |
| Collari doppi in polipropilene, poliammide autoestinguente o gomma <i>Double clamps in polypropylene, self-extinguishing polyamide or rubber</i> | 11 |
| Collari serie pesante in polipropilene, poliammide autoestinguente, alluminio o gomma <i>Heavy duty clamps in polypropylene, self-extinguishing polyamide, aluminium or rubber</i> | 14 |
| Piastre doppie per serie pesante <i>Double plates for heavy duty series</i> | 19 |
| Collari doppi serie pesante in polipropilene o poliammide autoestinguente <i>Heavy duty double clamps in polypropylene and self-extinguishing polyamid</i> | 20 |
| Piastre speciali per serie standard <i>Special plates for standard series</i> | 21 |
| Collari serie standard per tubi gemellati <i>Standard series clamps for twin tubes</i> | 22 |
| Elementi di fissaggio per tubi rigidi, flessibili e cavi elettrici <i>Clamps for hoses, pipes, tubes and cables</i> | 23 |
| Supporto tra tubo e cilindro <i>Pipe clamp for cylinder</i> | 24 |
| Caratteristiche materiali <i>Materials properties</i> | 25 |

Suggerimenti per il montaggio

Montaggio con piastra a saldare

Posizionare la piastra inferiore nella posizione pre-scelta e bloccarla con un magnete o con un'appropriata attrezzatura. Saldare quindi la piastra. Inserire il semiguscio inferiore della staffa, posizionare il tubo, mettere il secondo semiguscio e serrare le viti. Non saldare la piastra inferiore con la staffa di plastica montata, le piastre inferiori allungate possono essere avvitate direttamente sul telaio della macchina. Attenzione agli interassi dei tubi (si sconsiglia il contatto fra due staffe).

Montaggio con binario

I binari sono forniti con lunghezza di 2 metri. Saldare o avvitare il binario sul telaio della macchina, inserire il dado scorrevole nel binario e girarlo leggermente in modo che non possa ruotare, inserire la parte inferiore della staffa, posizionare il tubo, mettere il secondo semiguscio e serrare le viti. Attenzione agli interassi dei tubi (si sconsiglia il contatto fra due staffe).

Montaggio raggruppato

Consiste nel montare due staffe una sopra l'altra usando due viti speciali. Con questo montaggio si possono raggruppare due o più staffe bloccando le viti speciali con un'appropriata piastrina di sicurezza.

Mounting details

Weld plate mounting

Weld lower plate in position. Press on lower clamp half, lay tube, put on top clamp half, insert screws and tighten. Don't weld with plastic clamps on them. Prolonged lower plate can be screwed directly to the surface. Ensure the clamp halves are not in contact with each other.

Rail mounting

Mounting rails are supplied in 2m lengths. Weld or screw mounting rail in position. Insert nut into rail and turn to fix at correct spacing. Press on lower clamp half, lay tube, put on top clamp half, insert screw and tighten. Ensure the clamp halves are not in contact with each other.

Stacking

Consists of 2 clamp halves, stacking bolt(s) and a bolt locking plate. To construct a stack, fasten a weld plate or rail nut and locate 2 clamp halves and tube, securing with stacking bolt(s). Once tight, these bolts must be held with a locking plate. The next clamp can then be assembled and so on, until the stack is complete, the last clamp being secured with conventional bolt(s) and top plate. For each stack a mounting shape of your choice should be ordered, components from wich start and finish the stack. We reserve the right to make modifications in the interest of technical progress.

Distanza suggerita tra una staffa e l'altra dello stesso gruppo.
Recommend distance for installation of clamps of same group code.
Empfohlener Schellenabstand.
Distance conseillée entre les colliers.

| Ø est. tubo - Ø tube Rohr-AD / Tube-OD in mm | Distanza fra le staffe in m Distances of clamps in meters Schellenabstand in m Distance entre les colliers en mètres |
|--|---|
| a 6 bis 12,7 | 0,9 |
| a 15 bis 22 | 1,2 |
| a 23 bis 28 | 1,5 |
| a 30 bis 38,1 | 2 |
| a 40 bis 48,3 | 2,5 |
| a 50 bis 57 | 3 |
| a 60 bis 70 | 3,4 |
| a 76,1 bis 88,9 | 3,7 |
| a 101,6 bis 108 | 4 |
| a 114,3 bis 133 | 4,3 |
| a 139,7 bis 165,1 | 5 |
| a 168,3 bis 324 | 5,5 |

Posizionare le staffe prima e dopo una curva a 90° (a gomito)
When an elbow or bend be supported the clamps, should be positioned as close as possible on each side of the bend.

Rohrbögen direkt vor und hinter dem Bogen mit RSB-Schellen abfangen.
Monter les colliers avant et après une courbe à 90°.

Montagehinweise

Montage auf Anschweißplatten

Anschweißplatten auf einer mit der Belastung abgestimmten Unterlage anschweißen. Untere Schellenhälfte auf Anschweißplatte klemmen, Rohr einlegen, zweite Schellenhälfte aufsetzen und mit den Schrauben festziehen. Nicht mit aufgesetzter Kunststoff-Schelle schweißen! Verlängerte Anschweißplatten können mit der Unterlage verschraubt werden.

Auf Vorspannung achten (Schellenhälften dürfen sich nach der Montage nicht berühren)!

Montage auf Tragschienen

Tragschienen werden wahlweise in Stücken zu 2 m geliefert. Tragschiene anschweißen oder mit Befestigungswinkel anschrauben. Tragschienenmuttern in Schiene einführen und bis zum Anschlag drehen (auf richtigen Abstand achten). Untere Schellenhälfte aufkleben, Rohr einlegen, zweite Schellenhälfte aufsetzen und mit den Schrauben festziehen. Auf Vorspannung achten (Schellenhälften dürfen sich nach Montage nicht berühren)!

Aufbaumontage

Anschweißplatte oder Tragschiene anschweißen oder mit Befestigungswinkel anschrauben. Untere Schellenhälfte aufkleben, Rohr einlegen, obere Schellenhälfte aufsetzen und mit Aufbauschrauben festziehen (Aufbauschraube steht über). Durch Auflegen eines Sicherungsbleches auf die obere Schellenhälfte wird ein Verdrehen der Aufbauschraube verhindert. Zweite Rohrschelle nun in gleicher Weise aufmontieren usw. Form und Maßänderungen, die der technischen Entwicklung dienen, vorbehalten.

Conseils pour le montage

Montage avec plaque à souder

Poser la plaque inférieure et fixer avec un aimant, ou bien avec un autre outillage. Souder la plaque; poser le collier inférieur, le tube, le deuxième demi-collier et serrer les vis. Ne pas souder la plaque inférieure après le montage du collier en plastique.

Les plaques inférieures allongées sont capables pour le montage direct sur le châssis de la machine. Il faut bien contrôler la distance entre les tubes (le contact entre les colliers est déconseillé).

Montage avec rail support

Les rails supports sont livrés en longueur 2 mètres. Souder ou bien visser le rail sur le châssis de la machine, insérer le contre écrou hexagonal dans le rail et le tourner, poser le collier inférieur, poser le tube, poser le deuxième demi-collier et serrer les vis. Il faut bien contrôler la distance entre les tubes (le contact entre les colliers est déconseillé).

Montage groupé

C'est le montage de deux colliers, un au-dessus de l'autre par deux vis spéciales. Par ce montage c'est possible de grouper, deux ou bien plusieurs colliers en bloquant les vis spéciales par une propre plaque de sécurité.

Max. momento torcente per il fissaggio delle viti. Staffe con piastra superiore.

Max. bolt tightening Torque in Nm, for clamps with upper plate.

Max. Schraubenanzugsmoment in Nm, montage mit Deckplatte.

Max. effort en Nm, montage avec plaque supérieure.

| Serie – Series Baureihe – Série | | | n° tu/Werkstoff/Material/Matériel | | |
|---------------------------------------|-----------|------|-----------------------------------|-----------|-----------|
| | | | Polypropylen | Polyamide | Aluminium |
| Standard | | M 6 | 8 | 10 | 12 |
| Doppia – Twin Doppel – Double | Gr. 1 | M 6 | 5 | 6 | - |
| | Gr. 2 ÷ 4 | M 8 | 12 | 12 | - |
| | Gr. 5 | | 8 | 8 | - |
| Pesante Heavy Schwere Lourde | Gr. 1 | M 10 | 12 | 20 | 30 |
| | Gr. 2 | | 12 | 20 | 30 |
| | Gr. 3 | | 15 | 25 | 35 |
| | Gr. 4 | M 12 | 30 | 40 | 55 |
| | Gr. 5 | M 16 | 45 | 55 | 120 |
| | Gr. 6 | M 20 | 80 | 150 | 220 |
| | Gr. 7 | M 24 | 110 | 200 | 250 |
| | Gr. 8 | M 30 | 180 | 350 | 500 |
| Gr. 9 | M 30 | 200 | 370 | 500 | |

Programma di produzione Production program

gruppo
group

0

gruppo
group

1÷6

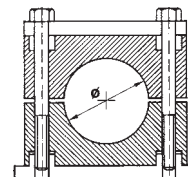
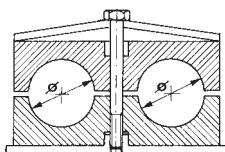
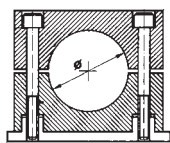
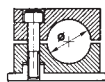

| collari serie standard standard clamps | | | |
|---|--------------------------------|-------------------------------------|----------------------------|
| gruppo - group | diametro tubo pipe diameter | | |
| | Ø mm | foro nominale nominal bore | Ø pollici inch. O.D. |
| 0 | 6 | | |
| | 8 | | 5/16" |
| | 10 | G 1/8" | |
| | 12 | | |
| 1 | 6 | | |
| | 6,4 | | 1/4" |
| | 8 | | 5/16" |
| | 9,5 | | 3/8" |
| | 10 | G 1/8" | |
| 2 | 12,7 | | 1/2" |
| | 13,5 | G 1/4" | |
| | 14 | | |
| | 15 | | |
| | 16 | | 5/8" |
| | 17,2 | G 3/8" | |
| | 18 | | |
| 3 | 19 | | 3/4" |
| | 20 | | |
| | 21,3 | G 1/2" | |
| | 22 | | 7/8" |
| | 25 | | |
| 4 | 25,4 | | 1" |
| | 26,9 | G 3/4" | |
| | 28 | | |
| | 30 | | |
| 5 | 32 | | 1 1/4" |
| | 33,7 | G 1" | |
| | 35 | | |
| | 38 | | 1 1/2" |
| | 40 | | |
| 6 | 42,4 | G 1 1/4" | |
| | 44,5 | | 1 3/4" |
| | 48,3 | G 1 1/2" | |
| | 50,8 | | 2" |

| collari doppi double clamps | | | |
|--------------------------------|--------------------------------|-------------------------------------|----------------------------|
| gruppo - group | diametro tubo pipe diameter | | |
| | Ø mm | foro nominale nominal bore | Ø pollici inch. O.D. |
| 1 | 6 | | |
| | 6,4 | | 1/4" |
| | 8 | | 5/16" |
| | 9,5 | | 3/8" |
| | 10 | G 1/8" | |
| 2 | 12,7 | | 1/2" |
| | 13,5 | G 1/4" | |
| | 14 | | |
| | 15 | | |
| | 16 | | 5/8" |
| | 17,2 | G 3/8" | |
| | 18 | | |
| 3 | 19 | | 3/4" |
| | 20 | | |
| | 21,3 | G 1/2" | |
| | 22 | | 7/8" |
| | 25 | | |
| 4 | 25,4 | | 1" |
| | 26,9 | G 3/4" | |
| | 28 | | |
| 5 | 30 | | |
| | 32 | | 1 1/4" |
| | 33,7 | G 1" | |
| | 35 | | |
| | 38 | | 1 1/2" |
| | 40 | | |
| | 42,4 | G 1 1/4" | |

| collari serie pesante heavy duty clamps | | | | | | | |
|--|--------------------------------|-------------------------------------|----------------------------|----------------|--------------------------------|-------------------------------------|----------------------------|
| gruppo - group | diametro tubo pipe diameter | | | gruppo - group | diametro tubo pipe diameter | | |
| | Ø mm | foro nominale nominal bore | Ø pollici inch. O.D. | | Ø mm | foro nominale nominal bore | Ø pollici inch. O.D. |
| 1 | 6 | | | 5 | 65 | | |
| | 6,4 | | 1/4" | | 70 | | 2 3/4" |
| | 8 | | 5/16" | | 75 | | |
| | 9,5 | | 3/8" | | 76,1 | G 2 1/2" | 3" |
| | 10 | G 1/8" | | | 80 | | 3 1/4" |
| | 12 | | | | 82,5 | | 3 1/2" |
| | 12,7 | | 1/2" | | 88,9 | G 3" | 3 1/2" |
| | 13,5 | G 1/4" | | | 88,9 | G 3" | 3 1/2" |
| | 14 | | | | 100 | | 4" |
| | 15 | | | | 101,6 | G 3 1/2" | 4" |
| 2 | 16 | | 5/8" | 6 | 108 | | 4 1/4" |
| | 16 | | 5/8" | | 114,3 | G 4" | 4 1/2" |
| | 17,2 | G 3/8" | | | 127 | G 4 1/2" | 5" |
| | 18 | | | | 133 | | 5 1/2" |
| | 19 | | 3/4" | | 133 | | 5 1/4" |
| | 20 | | | | 139,7 | G 5" | 5 1/2" |
| | 21,3 | G 1/2" | | | 152,4 | G 5 1/2" | 6" |
| | 22 | | 7/8" | | 165 | | 6 1/2" |
| | 25 | | | | 168,3 | G 6" | |
| | 25,4 | | 1" | | 168,3 | G 6" | |
| 3 | 26,9 | G 3/4" | | 7 | 177,8 | | 7" |
| | 28 | | | | 193,7 | | 7 5/8" |
| | 30 | | | | 216 | | 8 1/2" |
| | 32 | | 1 1/4" | | 219,1 | G 8" | |
| | 33,7 | G 1" | | | | | |
| | 35 | | | | | | |
| | 38 | | | | | | |
| | 40 | | 1 1/2" | | | | |
| | 42 | | | | | | |
| | 42,4 | G 1 1/4" | | | | | |
| 4 | 38 | | 1 1/2" | 8 | | | |
| | 42 | | | | | | |
| | 42,4 | G 1 1/4" | | | | | |
| | 44,5 | | 1 3/4" | | | | |
| | 48,3 | G 1 1/2" | | | | | |
| | 50 | | | | | | |
| | 50,8 | | 2" | | | | |
| | 55 | | | | | | |
| | 57 | | 2 1/4" | | | | |
| | 60,3 | G 2" | | | | | |
| 63,5 | | 2 1/2" | | | | | |
| 65 | | | | | | | |
| 70 | | 2 3/4" | | | | | |

**Collari serie standard
in polipropilene,
poliammide autoestinguente,
gomma o alluminio**

**Standard clamps
in polypropylene,
self-extinguishing polyamide,
rubber or aluminium**

gruppo
group

0

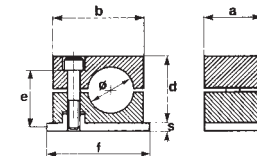

gruppo
group

1÷6

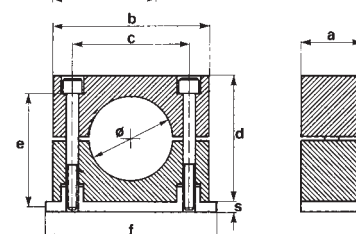

| gruppo - group | diametro tubo pipe diameter | | | tipo di collare clamp type | | | | dimensioni in mm dimension in mm | | | | | | pezzi per confezione box quantity | |
|----------------|--------------------------------|-----------------------|-----------------------|-------------------------------------|---------------------------------------|------------------------|------------------------------|-------------------------------------|----|----|----|------|---|--------------------------------------|----|
| | Ø mm | pollici / inches G | Ø O.D. | A polipropilene polypropylene | MA polyamide self-extinguishing | RA gomma rubber | LA alluminio aluminium | a | b | c | d | f | s | | e |
| 0 | 6 | | | A ₀ 06 | MA ₀ 06 | – | – | 30 | 28 | – | 27 | 31,5 | 3 | M6x20 | 50 |
| | 8 | | 5/16" | A ₀ 08 | MA ₀ 08 | – | – | | | | | | | | |
| | 10 | 1/8" | | A ₀ 10 | MA ₀ 10 | – | – | | | | | | | | |
| | 12 | | | A ₀ 12 | MA ₀ 12 | – | – | | | | | | | | |
| 1 | 6 | | | A ₁ 06 | MA ₁ 06 | RA ₁ 06 | LA ₁ 06 | 30 | 34 | 20 | 27 | 41 | 3 | M6x20 | 50 |
| | 6,4 | | 1/4" | A ₁ 6,4 | MA ₁ 6,4 | RA ₁ 6,4 | LA ₁ 6,4 | | | | | | | | |
| | 8 | | 5/16" | A ₁ 08 | MA ₁ 08 | RA ₁ 08 | LA ₁ 08 | | | | | | | | |
| | 9,5 | | 3/8" | A ₁ 9,5 | MA ₁ 9,5 | RA ₁ 9,5 | LA ₁ 9,5 | | | | | | | | |
| | 10 | 1/8" | | A ₁ 10 | MA ₁ 10 | RA ₁ 10 | LA ₁ 10 | | | | | | | | |
| 2 | 12,7 | | 1/2" | A ₂ 12,7 | MA ₂ 12,7 | RA ₂ 12,7 | LA ₂ 12,7 | 30 | 40 | 26 | 33 | 46 | 3 | M6x25 | 50 |
| | 13,5 | 1/4" | | A ₂ 1/4" | MA ₂ 1/4" | RA ₂ 1/4" | LA ₂ 1/4" | | | | | | | | |
| | 14 | | | A ₂ 14 | MA ₂ 14 | RA ₂ 14 | LA ₂ 14 | | | | | | | | |
| | 15 | | | A ₂ 15 | MA ₂ 15 | RA ₂ 15 | LA ₂ 15 | | | | | | | | |
| | 16 | | 5/8" | A ₂ 16 | MA ₂ 16 | RA ₂ 16 | LA ₂ 16 | | | | | | | | |
| | 17,2 | 3/8" | | A ₂ 3/8" | MA ₂ 3/8" | RA ₂ 3/8" | LA ₂ 3/8" | | | | | | | | |
| | 18 | | | A ₂ 18 | MA ₂ 18 | RA ₂ 18 | LA ₂ 18 | | | | | | | | |
| 19 | | 3/4" | A ₂ 19 | MA ₂ 19 | RA ₂ 19 | LA ₂ 19 | | | | | | | | | |
| 3 | 19 | | 3/4" | A ₃ 19 | MA ₃ 19 | RA ₃ 19 | LA ₃ 19 | 30 | 48 | 33 | 35 | 54 | 3 | M6x30 | 50 |
| | 20 | | | A ₃ 20 | MA ₃ 20 | RA ₃ 20 | LA ₃ 20 | | | | | | | | |
| | 21,3 | 1/2" | | A ₃ 1/2" | MA ₃ 1/2" | RA ₃ 1/2" | LA ₃ 1/2" | | | | | | | | |
| | 22 | | 7/8" | A ₃ 22 | MA ₃ 22 | RA ₃ 22 | LA ₃ 22 | | | | | | | | |
| | 25 | | | A ₃ 25 | MA ₃ 25 | RA ₃ 25 | LA ₃ 25 | | | | | | | | |
| 4 | 25,4 | 1" | | A ₃ 25,4 | MA ₃ 25,4 | RA ₃ 25,4 | LA ₃ 25,4 | 30 | 57 | 40 | 42 | 61 | 3 | M6x35 | 25 |
| | 26,9 | 3/4" | | A ₄ 3/4" | MA ₄ 3/4" | RA ₄ 3/4" | LA ₄ 3/4" | | | | | | | | |
| | 28 | | | A ₄ 28 | MA ₄ 28 | RA ₄ 28 | LA ₄ 28 | | | | | | | | |
| | 30 | | | A ₄ 30 | MA ₄ 30 | RA ₄ 30 | LA ₄ 30 | | | | | | | | |
| 5 | 32 | | 1 1/4" | A ₄ 32 | MA ₄ 32 | RA ₄ 32 | LA ₄ 32 | 30 | 68 | 52 | 58 | 73 | 3 | M6x50 | 25 |
| | 32 | | 1 1/4" | A ₅ 32 | MA ₅ 32 | RA ₅ 32 | LA ₅ 32 | | | | | | | | |
| | 33,7 | 1" | | A ₅ 1" | MA ₅ 1" | RA ₅ 1" | LA ₅ 1" | | | | | | | | |
| | 35 | | | A ₅ 35 | MA ₅ 35 | RA ₅ 35 | LA ₅ 35 | | | | | | | | |
| | 38 | | 1 1/2" | A ₅ 38 | MA ₅ 38 | RA ₅ 38 | LA ₅ 38 | | | | | | | | |
| | 40 | | | A ₅ 40 | MA ₅ 40 | RA ₅ 40 | LA ₅ 40 | | | | | | | | |
| | 42 | | | A ₅ 42 | MA ₅ 42 | RA ₅ 42 | LA ₅ 42 | | | | | | | | |
| 42,4 | 1 1/4" | | A ₅ 1 1/4" | MA ₅ 1 1/4" | RA ₅ 1 1/4" | LA ₅ 1 1/4" | | | | | | | | | |
| 45 | | | A ₅ 45 | MA ₅ 45 | RA ₅ 45 | LA ₅ 45 | | | | | | | | | |
| 6 | 44,5 | | 1 3/4" | A ₆ 44,5 | MA ₆ 44,5 | RA ₆ 44,5 | LA ₆ 44,5 | 30 | 86 | 66 | 66 | 89 | 3 | M6x60 | 25 |
| | 48,3 | 1 1/2" | | A ₆ 1 1/2" | MA ₆ 1 1/2" | RA ₆ 1 1/2" | LA ₆ 1 1/2" | | | | | | | | |
| | 50,8 | 2" | | A ₆ 50,8 | MA ₆ 50,8 | RA ₆ 50,8 | LA ₆ 50,8 | | | | | | | | |

A... = polipropilene / polypropylene* MA... = polyamide / self-extinguishing RA... = gomma / rubber LA... = alluminio / aluminium
 ...H = interno liscio / smooth inside (per ordine di collari tipo H, aggiungere H dopo il codice / to order clamps type H, please put the H at the end of the code)

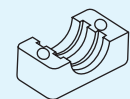

tipo normale
interno sagomato
normal model
profiled inside

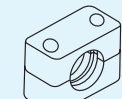

tipo normale
interno sagomato
normal model
profiled inside

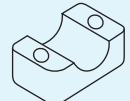

tipo H
interno liscio
H model
smooth inside

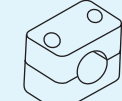

tipo H
interno liscio
H model
smooth inside

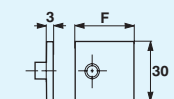

gruppo
group

0

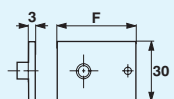

gruppo
group

0

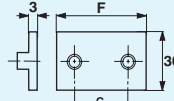

gruppo
group

1 ÷ 6

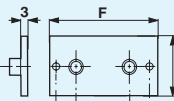

gruppo
group

1 ÷ 6

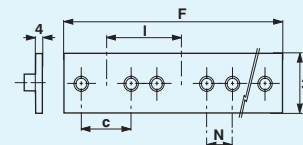
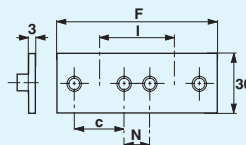

| semi-collare clamp-half | coppia collari clamp body (2 halves) | piastra inferiore lower plate | | piastra inferiore allungata prolonged lower plate | | | piastra inferiore doppia double lower plate | | | | | piastra inferiore multipla multiple lower plate | | | | |
|----------------------------|--|----------------------------------|---------|--|---------|---------|--|---------|---------|---------|-------------------------|--|---------|---------|---------|-------------------------|
| | | APIN | | APIA | | | APID | | | | | APIM | | | | |
| A....S | A....C | F mm | c mm | F mm | c mm | d mm | F mm | c mm | N mm | l mm | n° collari clamps | F mm | c mm | N mm | l mm | n° collari clamps |
| A ₀ 06 S | A ₀ 06 C | APIN₀ | | APIA₀ | | | APID₀ | | | | | APIM₀ | | | | |
| A ₀ 08 S | A ₀ 08 C | | | | | | | | | | | | | | | |
| A ₀ 10 S | A ₀ 10 C | 31,5 | - | 46 | - | - | 63 | - | - | 30 | 2 | 315 | - | - | 30 | 10 |
| A ₀ 12 S | A ₀ 12 C | | | | | | | | | | | | | | | |
| A ₁ 06 S | A ₁ 06 C | APIN₁ | | APIA₁ | | | APID₁ | | | | | APIM₁ | | | | |
| A ₁ 6,4 S | A ₁ 6,4 C | | | | | | | | | | | | | | | |
| A ₁ 08 S | A ₁ 08 C | | | | | | | | | | | | | | | |
| A ₁ 9,5 S | A ₁ 9,5 C | 41 | 20 | 64 | 20 | 51 | 82 | 20 | 20 | 40 | 2 | 410 | 20 | 20 | 40 | 10 |
| A ₁ 10 S | A ₁ 10 C | | | | | | | | | | | | | | | |
| A ₁ 12 S | A ₁ 12 C | | | | | | | | | | | | | | | |
| A ₂ 12,7 S | A ₂ 12,7 | APIN₂ | | APIA₂ | | | APID₂ | | | | | APIM₂ | | | | |
| A ₂ 1/4" S | A ₂ 1/4" C | | | | | | | | | | | | | | | |
| A ₂ 14 S | A ₂ 14 C | | | | | | | | | | | | | | | |
| A ₂ 15 S | A ₂ 15 C | | | | | | | | | | | | | | | |
| A ₂ 16 S | A ₂ 16 C | 46 | 26 | 70 | 26 | 56 | 92 | 26 | 18 | 44 | 2 | 460 | 26 | 18 | 44 | 10 |
| A ₂ 3/8" S | A ₂ 3/8" C | | | | | | | | | | | | | | | |
| A ₂ 18 S | A ₂ 18 C | | | | | | | | | | | | | | | |
| A ₂ 19 S | A ₂ 19 C | | | | | | | | | | | | | | | |
| A ₃ 19 S | A ₃ 19 C | APIN₃ | | APIA₃ | | | APID₃ | | | | | APIM₃ | | | | |
| A ₃ 20 S | A ₃ 20 C | | | | | | | | | | | | | | | |
| A ₃ 1/2" S | A ₃ 1/2" C | | | | | | | | | | | | | | | |
| A ₃ 22 S | A ₃ 22 C | 54 | 33 | 78 | 33 | 64 | 108 | 33 | 19 | 52 | 2 | 540 | 33 | 19 | 52 | 10 |
| A ₃ 25 S | A ₃ 25 C | | | | | | | | | | | | | | | |
| A ₃ 25,4 S | A ₃ 25,4 C | | | | | | | | | | | | | | | |
| A ₄ 3/4" S | A ₄ 3/4" C | APIN₄ | | APIA₄ | | | APID₄ | | | | | APIM₄ | | | | |
| A ₄ 28 S | A ₄ 28 C | | | | | | | | | | | | | | | |
| A ₄ 30 S | A ₄ 30 C | 61 | 40 | 86 | 40 | 71 | 122 | 40 | 20 | 60 | 2 | 305 | 40 | 20 | 60 | 5 |
| A ₄ 32 S | A ₄ 32 C | | | | | | | | | | | | | | | |
| A ₅ 32 S | A ₅ 32 C | APIN₅ | | APIA₅ | | | APID₅ | | | | | APIM₅ | | | | |
| A ₅ 1" S | A ₅ 1" C | | | | | | | | | | | | | | | |
| A ₅ 35 S | A ₅ 35 C | | | | | | | | | | | | | | | |
| A ₅ 38 S | A ₅ 38 C | | | | | | | | | | | | | | | |
| A ₅ 40 S | A ₅ 40 C | 73 | 52 | 97 | 52 | 83 | 146 | 52 | 23 | 75 | 2 | 365 | 52 | 23 | 75 | 5 |
| A ₅ 42 S | A ₅ 42 C | | | | | | | | | | | | | | | |
| A ₅ 1 1/4" S | A ₅ 1 1/4" C | | | | | | | | | | | | | | | |
| A ₅ 45 S | A ₅ 45 C | | | | | | | | | | | | | | | |
| A ₆ 44,5 S | A ₆ 44,5 C | APIN₆ | | APIA₆ | | | APID₆ | | | | | APIM₆ | | | | |
| A ₆ 1 1/2" S | A ₆ 1 1/2" C | | | | | | | | | | | | | | | |
| A ₆ 50,8 S | A ₆ 50,8 C | 89 | 66 | 112 | 66 | 100 | 178 | 66 | 24 | 90 | 2 | 445 | 66 | 24 | 90 | 5 |

* La produzione standard è di colore verde, colore nero su richiesta.
 Standard production in green, black color on request.

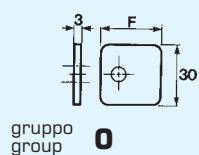
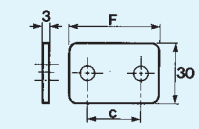
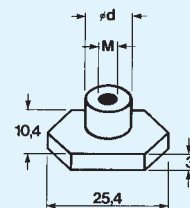
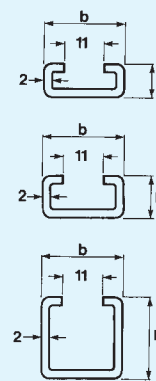
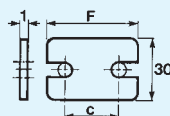
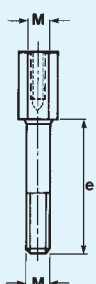
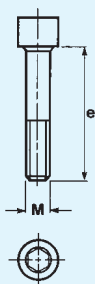
gruppo
group **0**gruppo
group **1 ÷ 6**

| piastra superiore upper plate | vite a testa tonda esagono interno T.C.E.I. screws | vite a testa esagonale hexagonal head screw | vite a testa esag. allungata high hexeg. head screw | piastra superiore di sicurezza security upper plate | binari portanti spessore 2 mm rail | dado esagonale fissaggio binari hexagonal nut | | |
|----------------------------------|--|--|--|---|--|---|----------------|----|
| APS | AVTC | AVTE | AVTEA | APMRS | ABINS | ADES | | |
| F mm | c mm | M | e mm | M | e mm | M | ø d mm | |
| APS₀ | AVTC₀ | AVTE₀ | AVTEA₀ | APMRS₀ | ABINS-1 | ADES | | |
| 28 | — | M6 20 | M6 30 | M6 20 | | | 28 | — |
| APS₁ | AVTC₁ | AVTE₁ | AVTEA₁ | APMRS₁ | ABINS-1 | ADES | | |
| 37 | 20 | M6 20 | M6 30 | M6 20 | | | 34 | 20 |
| APS₂ | AVTC₂ | AVTE₂ | AVTEA₂ | APMRS₂ | | | 28 | 11 |
| 43 | 26 | M6 25 | M6 35 | M6 25 | 41 | 26 | ABINS-2 | |
| APS₃ | AVTC₃ | AVTE₃ | AVTEA₃ | APMRS₃ | 28 | 14 | | |
| 50 | 33 | M6 30 | M6 40 | M6 30 | 47 | 33 | ABINS-3 | |
| APS₄ | AVTC₄ | AVTE₄ | AVTEA₄ | APMRS₄ | 28 | 30 | | |
| 57 | 40 | M6 35 | M6 45 | M6 35 | 57 | 40 | ABINS-3 | |
| APS₅ | AVTC₅ | AVTE₅ | AVTEA₅ | APMRS₅ | 67 | 52 | | |
| 69 | 52 | M6 50 | M6 60 | M6 50 | 67 | 52 | ABINS-3 | |
| APS₆ | AVTC₆ | AVTE₆ | AVTEA₆ | APMRS₆ | 82 | 66 | | |
| 83 | 66 | M6 60 | M6 70 | M6 60 | 82 | 66 | | |

* Altre piastre speciali sono a pag. 20
Other special plate are at page 20

Collari serie standard con piastra superiore in polipropilene, poliammide autoestinguente, gomma o alluminio

Standard clamps with upper plate in polypropylene, self-extinguishing polyamide, rubber or aluminium

gruppo
group

0

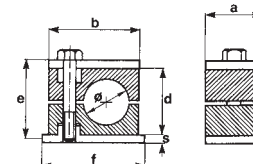

gruppo
group

1÷6

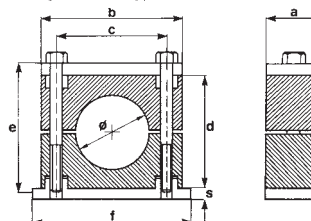

| gruppo - group | diametro tubo pipe diameter | | tipo di collare clamp type | | | | dimensioni in mm dimension in mm | | | | | | | pezzi per confezione box quantity |
|----------------|--------------------------------|---------------------------------|-------------------------------------|--|----------------------------|------------------------------|-------------------------------------|----|----|----|----|---|-------|--------------------------------------|
| | Ø mm | pollici / inches G Ø O.D. | A polipropilene polypropylene | MA poliammide self-extinguishing | RA gomma rubber | LA alluminio aluminium | a | b | c | d | f | s | e | |
| 0 | 6 | | A ₀ 06 +APS | MA ₀ 06 +APS | — | — | 30 | 28 | — | 27 | 32 | 3 | M6x30 | 50 |
| | 8 | 5/16" | A ₀ 08 +APS | MA ₀ 08 +APS | — | — | | | | | | | | |
| | 10 | 1/8" | A ₀ 10 +APS | MA ₀ 10 +APS | — | — | | | | | | | | |
| | 12 | | A ₀ 12 +APS | MA ₀ 12 +APS | — | — | | | | | | | | |
| 1 | 6 | | A ₁ 06 +APS | MA ₁ 06 +APS | RA ₁ 06 +APS | LA ₁ 06 +APS | 30 | 34 | 20 | 27 | 42 | 3 | M6x30 | 50 |
| | 6,4 | 1/4" | A ₁ 6,4 +APS | MA ₁ 6,4 +APS | RA ₁ 6,4 +APS | LA ₁ 6,4 +APS | | | | | | | | |
| | 8 | 5/16" | A ₁ 08 +APS | MA ₁ 08 +APS | RA ₁ 08 +APS | LA ₁ 08 +APS | | | | | | | | |
| | 9,5 | 3/8" | A ₁ 9,5 +APS | MA ₁ 9,5 +APS | RA ₁ 9,5 +APS | LA ₁ 9,5 +APS | | | | | | | | |
| | 10 | 1/8" | A ₁ 10 +APS | MA ₁ 10 +APS | RA ₁ 10 +APS | LA ₁ 10 +APS | | | | | | | | |
| | 12 | | A ₁ 12 +APS | MA ₁ 12 +APS | RA ₁ 12 +APS | LA ₁ 12 +APS | | | | | | | | |
| 2 | 12,7 | 1/2" | A ₂ 12,7+APS | MA ₂ 12,7+APS | RA ₂ 12,7+APS | LA ₂ 12,7+APS | 30 | 40 | 26 | 33 | 48 | 3 | M6x35 | 50 |
| | 13,5 | 1/4" | A ₂ 1/4"+APS | MA ₂ 1/4"+APS | RA ₂ 1/4"+APS | LA ₂ 1/4"+APS | | | | | | | | |
| | 14 | | A ₂ 14+APS | MA ₂ 14+APS | RA ₂ 14+APS | LA ₂ 14+APS | | | | | | | | |
| | 15 | | A ₂ 15+APS | MA ₂ 15+APS | RA ₂ 15+APS | LA ₂ 15+APS | | | | | | | | |
| | 16 | 5/8" | A ₂ 16+APS | MA ₂ 16+APS | RA ₂ 16+APS | LA ₂ 16+APS | | | | | | | | |
| | 17,2 | 3/8" | A ₂ 3/8"+APS | MA ₂ 3/8"+APS | RA ₂ 3/8"+APS | LA ₂ 3/8"+APS | | | | | | | | |
| | 18 | | A ₂ 18+APS | MA ₂ 18+APS | RA ₂ 18+APS | LA ₂ 18+APS | | | | | | | | |
| 19 | 3/4" | A ₂ 19+APS | MA ₂ 19+APS | RA ₂ 19+APS | LA ₂ 19+APS | | | | | | | | | |
| 3 | 19 | 3/4" | A ₃ 19+APS | MA ₃ 19+APS | RA ₃ 19+APS | LA ₃ 19+APS | 30 | 48 | 33 | 35 | 55 | 3 | M6x40 | 50 |
| | 20 | | A ₃ 20+APS | MA ₃ 20+APS | RA ₃ 20+APS | LA ₃ 20+APS | | | | | | | | |
| | 21,3 | 1/2" | A ₃ 1/2"+APS | MA ₃ 1/2"+APS | RA ₃ 1/2"+APS | LA ₃ 1/2"+APS | | | | | | | | |
| | 22 | 7/8" | A ₃ 22+APS | MA ₃ 22+APS | RA ₃ 22+APS | LA ₃ 22+APS | | | | | | | | |
| | 25 | | A ₃ 25+APS | MA ₃ 25+APS | RA ₃ 25+APS | LA ₃ 25+APS | | | | | | | | |
| 25,4 | 1" | A ₃ 25,4+APS | MA ₃ 25,4+APS | RA ₃ 25,4+APS | LA ₃ 25,4+APS | | | | | | | | | |
| 4 | 26,9 | 3/4" | A ₄ 3/4"+APS | MA ₄ 3/4"+APS | RA ₄ 3/4"+APS | LA ₄ 3/4"+APS | 30 | 57 | 40 | 42 | 62 | 3 | M6x45 | 25 |
| | 28 | | A ₄ 28+APS | MA ₄ 28+APS | RA ₄ 28+APS | LA ₄ 28+APS | | | | | | | | |
| | 30 | | A ₄ 30+APS | MA ₄ 30+APS | RA ₄ 30+APS | LA ₄ 30+APS | | | | | | | | |
| | 32 | 1 1/4" | A ₄ 32+APS | MA ₄ 32+APS | RA ₄ 32+APS | LA ₄ 32+APS | | | | | | | | |
| 5 | 32 | 1 1/4" | A ₅ 32+APS | MA ₅ 32+APS | RA ₅ 32+APS | LA ₅ 32+APS | 30 | 68 | 52 | 58 | 74 | 3 | M6x60 | 25 |
| | 33,7 | 1" | A ₅ 1"+APS | MA ₅ 1"+APS | RA ₅ 1"+APS | LA ₅ 1"+APS | | | | | | | | |
| | 35 | | A ₅ 35+APS | MA ₅ 35+APS | RA ₅ 35+APS | LA ₅ 35+APS | | | | | | | | |
| | 38 | 1 1/2" | A ₅ 38+APS | MA ₅ 38+APS | RA ₅ 38+APS | LA ₅ 38+APS | | | | | | | | |
| | 40 | | A ₅ 40+APS | MA ₅ 40+APS | RA ₅ 40+APS | LA ₅ 40+APS | | | | | | | | |
| | 42 | | A ₅ 42+APS | MA ₅ 42+APS | RA ₅ 42+APS | LA ₅ 42+APS | | | | | | | | |
| | 42,4 | 1 1/4" | A ₅ 1 1/4"+APS | MA ₅ 1 1/4"+APS | RA ₅ 1 1/4"+APS | LA ₅ 1 1/4"+APS | | | | | | | | |
| 45 | | A ₅ 45+APS | MA ₅ 45+APS | RA ₅ 45+APS | LA ₅ 45+APS | | | | | | | | | |
| 6 | 44,5 | 1 3/4" | A ₆ 44,5+APS | MA ₆ 44,5+APS | RA ₆ 44,5+APS | LA ₆ 44,5+APS | 30 | 86 | 66 | 66 | 88 | 3 | M6x70 | 25 |
| | 48,3 | 1 1/2" | A ₆ 1 1/2"+APS | MA ₆ 1 1/2"+APS | RA ₆ 1 1/2"+APS | LA ₆ 1 1/2"+APS | | | | | | | | |
| | 50,8 | 2" | A ₆ 50,8+APS | MA ₆ 50,8+APS | RA ₆ 50,8+APS | LA ₆ 50,8+APS | | | | | | | | |

Collari doppi in polipropilene, poliammide autoestinguente o gomma

Double clamps in polypropylene, self-extinguishing polyamide or rubber

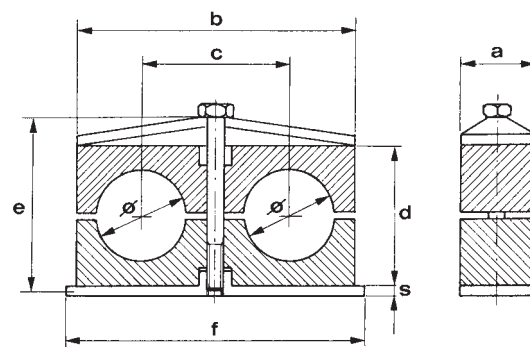

| gruppo - group | diametro tubo pipe diameter | | tipo di collare clamp type | | | dimensioni in mm dimension in mm | | | | | | pezzi per confezione box quantity | |
|----------------|--------------------------------|---------------------------------|--------------------------------------|--|----------------------------|-------------------------------------|-----|----|----|-----|---|--------------------------------------|----|
| | Ø mm | pollici / inches G Ø O.D. | AD polipropilene polypropylene | MD poliammide self-extinguishing | RD gomma rubber | a | b | c | d | f | s | | e |
| 1 | 6-6 | | AD ₁ 06-06 | MD ₁ 06-06 | RD ₁ 06-06 | 30 | 37 | 20 | 25 | 37 | 3 | MBx35 | 50 |
| | 6,4-6,4 | 1/4 - 1/4" | AD ₁ 6,4-6,4 | MD ₁ 6,4-6,4 | RD ₁ 6,4-6,4 | | | | | | | | |
| | 8-8 | 5/16 - 5/16" | AD ₁ 08-08 | MD ₁ 08-08 | RD ₁ 08-08 | | | | | | | | |
| | 9,5-9,5 | 3/8 - 3/8" | AD ₁ 9,5-9,5 | MD ₁ 9,5-9,5 | RD ₁ 9,5-9,5 | | | | | | | | |
| | 10-10 | 1/8 - 1/8" | AD ₁ 10-10 | MD ₁ 10-10 | RD ₁ 10-10 | | | | | | | | |
| | 12-12 | | AD ₁ 12-12 | MD ₁ 12-12 | RD ₁ 12-12 | | | | | | | | |
| 2 | 12,7 | 1/2 - 1/2" | AD ₂ 12,7-12,7 | MD ₂ 12,7-12,7 | RD ₂ 12,7-12,7 | 30 | 53 | 29 | 26 | 55 | 5 | MBx35 | 50 |
| | 13,5 | 1/4 - 1/4" | AD ₂ 1/4 - 1/4" | MD ₂ 1/4 - 1/4" | RD ₂ 1/4 - 1/4" | | | | | | | | |
| | 14-14 | | AD ₂ 14-14 | MD ₂ 14-14 | RD ₂ 14-14 | | | | | | | | |
| | 15-15 | | AD ₂ 15-15 | MD ₂ 15-15 | RD ₂ 15-15 | | | | | | | | |
| | 16-16 | 5/8 - 5/8" | AD ₂ 16-16 | MD ₂ 16-16 | RD ₂ 16-16 | | | | | | | | |
| | 17,2-17,2 | 3/8 - 3/8" | AD ₂ 3/8 - 3/8" | MD ₂ 3/8 - 3/8" | RD ₂ 3/8 - 3/8" | | | | | | | | |
| 18-18 | | AD ₂ 18-18 | MD ₂ 18-18 | RD ₂ 18-18 | | | | | | | | | |
| 3 | 19-19 | 3/4 - 3/4" | AD ₃ 19-19 | MD ₃ 19-19 | RD ₃ 19-19 | 30 | 67 | 36 | 37 | 70 | 5 | MBx45 | 50 |
| | 20-20 | | AD ₃ 20-20 | MD ₃ 20-20 | RD ₃ 20-20 | | | | | | | | |
| | 21,3-21,3 | 1/2 - 1/2" | AD ₃ 1/2 - 1/2" | MD ₃ 1/2 - 1/2" | RD ₃ 1/2 - 1/2" | | | | | | | | |
| | 22-22 | 7/8 - 7/8" | AD ₃ 22-22 | MD ₃ 22-22 | RD ₃ 22-22 | | | | | | | | |
| | 25-25 | | AD ₃ 25-25 | MD ₃ 25-25 | RD ₃ 25-25 | | | | | | | | |
| 25,4-25,4 | 1 - 1" | AD ₃ 25,4-25,4 | MD ₃ 25,4-25,4 | RD ₃ 25,4-25,4 | | | | | | | | | |
| 4 | 26,9 | 3/4 - 3/4" | AD ₄ 3/4 - 3/4" | MD ₄ 3/4 - 3/4" | RD ₄ 3/4 - 3/4" | 30 | 82 | 45 | 42 | 85 | 5 | MBx50 | 50 |
| | 28-28 | | AD ₄ 28-28 | MD ₄ 28-28 | RD ₄ 28-28 | | | | | | | | |
| | 30-30 | | AD ₄ 30-30 | MD ₄ 30-30 | RD ₄ 30-30 | | | | | | | | |
| 5 | 32-32 | 1 1/4 - 1 1/4" | AD ₅ 32-32 | MD ₅ 32-32 | RD ₅ 32-32 | 30 | 106 | 56 | 54 | 110 | 5 | MBx60 | 25 |
| | 33,7-33,7 | 1 - 1" | AD ₅ 1 - 1" | MD ₅ 1 - 1" | RD ₅ 1 - 1" | | | | | | | | |
| | 35-35 | | AD ₅ 35-35 | MD ₅ 35-35 | RD ₅ 35-35 | | | | | | | | |
| | 38-38 | 1 1/2 - 1 1/2" | AD ₅ 38-38 | MD ₅ 38-38 | RD ₅ 38-38 | | | | | | | | |
| | 40-40 | | AD ₅ 40-40 | MD ₅ 40-40 | RD ₅ 40-40 | | | | | | | | |
| | 42-42 | | AD ₅ 42-42 | MD ₅ 42-42 | RD ₅ 42-42 | | | | | | | | |
| 42,4-42,4 | 1 1/4 - 1 1/4" | AD ₅ 1 1/4 - 1 1/4" | MD ₅ 1 1/4 - 1 1/4" | RD ₅ 1 1/4 - 1 1/4" | | | | | | | | | |

AD*... = polipropilene / polypropylene

MD... = polyamide / self-extinguishing

RD... = gomma / rubber

...H = interno liscio / smooth inside (per ordine di collari tipo H, aggiungere H dopo il codice / to order clamps type H, please put the H at the end of the code)

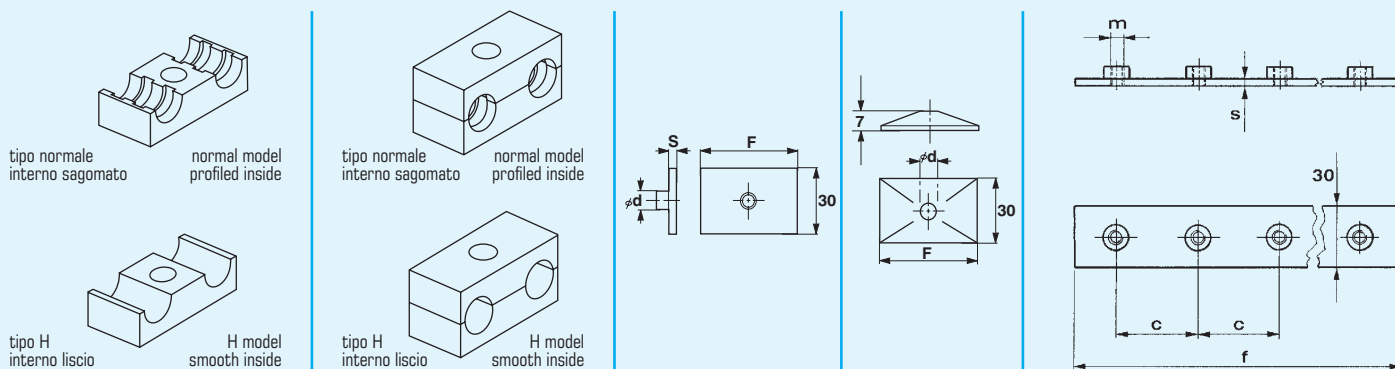

| semi-collare clamp-half | coppia collari clamp body (2 halves) | piastra inferiore lower plate | | | piastra superiore upper plate | | piastra inferiore multipla multiple lower plate | | | | |
|----------------------------------|---|----------------------------------|-----------|---|----------------------------------|-----------|--|---------|---------|----|----------------------|
| | | ADPIN | | | ADPS | | ADPIM | | | | |
| AD ... S | AD ... C | F mm | Ø d mm | S | F mm | Ø d mm | f mm | c mm | s mm | m | n° collari clamps |
| AD ₁ 06-06 S | AD ₁ 06-06 C | ADPIN₁ | | | ADPS₁ | | ADPIM₁ | | | | |
| AD ₁ 6,4-6,4 S | AD ₁ 6,4-6,4 C | 30 | 12 | 3 | 35 | 7 | 200 | 40 | 3 | M6 | 5 |
| AD ₁ 08-08 S | AD ₁ 08-08 C | | | | | | | | | | |
| AD ₁ 9,5-9,5 S | AD ₁ 9,5-9,5 C | | | | | | | | | | |
| AD ₁ 10-10 S | AD ₁ 10-10 C | | | | | | | | | | |
| AD ₁ 12-12 S | AD ₁ 12-12 C | | | | | | | | | | |
| AD ₂ 12,7-12,7 S | AD ₂ 12,7-12,7 C | | | | | | | | | | |
| AD ₂ 1/4 - 1/4" S | AD ₂ 1/4 - 1/4" C | 55 | 14 | 5 | 52 | 9 | 290 | 58 | 5 | M8 | 5 |
| AD ₂ 14-14 S | AD ₂ 14-14 C | | | | | | | | | | |
| AD ₂ 15-15 S | AD ₂ 15-15 C | | | | | | | | | | |
| AD ₂ 16-16 S | AD ₂ 16-16 C | | | | | | | | | | |
| AD ₂ 3/8 - 3/8" S | AD ₂ 3/8 - 3/8" C | | | | | | | | | | |
| AD ₂ 18-18 S | AD ₂ 18-18 C | | | | | | | | | | |
| AD ₃ 19-19 S | AD ₃ 19-19 C | ADPIN₃ | | | ADPS₃ | | ADPIM₃ | | | | |
| AD ₃ 20-20 S | AD ₃ 20-20 C | 70 | 14 | 5 | 66 | 9 | 360 | 72 | 5 | M8 | 5 |
| AD ₃ 1/2 - 1/2" S | AD ₃ 1/2 - 1/2" C | | | | | | | | | | |
| AD ₃ 22-22 S | AD ₃ 22-22 C | | | | | | | | | | |
| AD ₃ 25-25 S | AD ₃ 25-25 C | | | | | | | | | | |
| AD ₃ 25,4-25,4 S | AD ₃ 25,4-25,4 C | | | | | | | | | | |
| AD ₄ 3/4 - 3/4" S | AD ₄ 3/4 - 3/4" C | | | | | | | | | | |
| AD ₄ 28-28 S | AD ₄ 28-28 C | 85 | 14 | 5 | 81 | 9 | 450 | 90 | 5 | M8 | 5 |
| AD ₄ 30-30 S | AD ₄ 30-30 C | | | | | | | | | | |
| AD ₅ 32-32 S | AD ₅ 32-32 C | | | | | | | | | | |
| AD ₅ 1 - 1" S | AD ₅ 1 - 1" C | 110 | 14 | 5 | 105 | 9 | 560 | 112 | 5 | M8 | 5 |
| AD ₅ 35-35 S | AD ₅ 35-35 C | | | | | | | | | | |
| AD ₅ 38-38 S | AD ₅ 38-38 C | | | | | | | | | | |
| AD ₅ 40-40 S | AD ₅ 40-40 C | | | | | | | | | | |
| AD ₅ 42-42 S | AD ₅ 42-42 C | | | | | | | | | | |
| AD ₅ 1 1/4 - 1 1/4" S | AD ₅ 1 1/4 - 1 1/4" C | | | | | | | | | | |

* La produzione standard è di colore verde, colore nero su richiesta.
Standard production in green, black color on request.

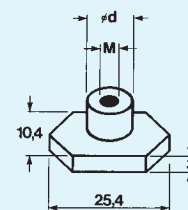
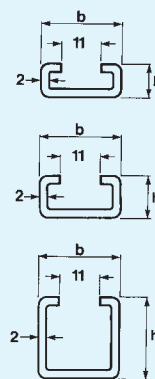
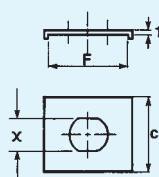
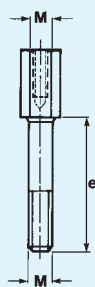

| vite a testa esagonale high hexagonal head screw | | vite a testa esagonale allungata high hexagonal head screw | | piastra superiore di sicurezza security upper plate | | | binari portanti spessore 2 mm rail | | dado esagonale fissaggio binari hexagonal nut | |
|---|---------|--|---------|--|---------|---------|---------------------------------------|---------|---|-----------|
| ADVTE | | ADVTEA | | APMRSD | | | ABINS | | ADES | |
| M | e mm | M | e mm | F mm | c mm | X mm | b mm | h mm | M | Ø d mm |
| ADVTE₁ | | ADVTEA₁ | | APMRSD₁ | | | | | ADES | |
| M6 | 35 | M6 | 20 | 30 | 30 | 11 | | | M6 | 12 |
| ADVTE₂ | | ADVTEA₂ | | APMRSD₂₋₅ | | | ABINS-1 | | | |
| M8 | 35 | M8 | 20 | 30 | 30 | 13 | 28 | 11 | | |
| ADVTE₃ | | ADVTEA₃ | | APMRSD₂₋₅ | | | ABINS-2 | | ADES_D | |
| M8 | 45 | M8 | 29 | 30 | 30 | 13 | 28 | 14 | M8 | 14 |
| ADVTE₄ | | ADVTEA₄ | | APMRSD₂₋₅ | | | ABINS-3 | | | |
| M8 | 50 | M8 | 34 | 30 | 30 | 13 | 28 | 30 | | |
| ADVTE₅ | | ADVTEA₅ | | APMRSD₂₋₅ | | | | | | |
| M8 | 60 | M8 | 47 | 30 | 30 | 13 | | | | |

**Collari serie pesante
in polipropilene,
poliammide autoestinguente,
alluminio o gomma**

**Heavy duty clamps
in polypropylene,
self-extinguishing polyamide,
aluminium or rubber**

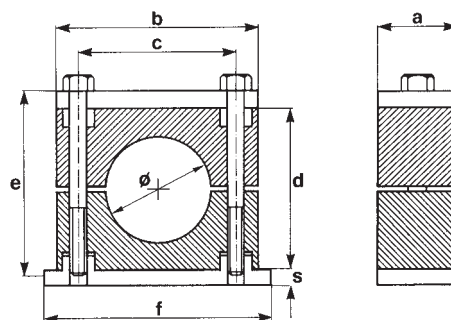

| gruppo - group | diametro tubo pipe diameter | | | tipo di collare clamp type | | | | dimensioni in mm dimension in mm | | | | | | |
|----------------|--------------------------------|-----------------------|-------------------------|---|--|---------------------------|----------------------------------|-------------------------------------|-----|----|----|-----|----|---------|
| | ϕ mm | pollici / inches G | ϕ O.D. | AMP.P polipropilene polypropylene | MMP.P polyamide self-extinguishing | RMP.P gomma rubber | AMLL.P alluminio aluminium | a | b | c | d | f | s | e |
| 1 | 6 | | | AMP.P ₁ 06 | MMP.P ₁ 06 | RMP.P ₁ 06 | AMLL.P ₁ 06 | 30 | 55 | 33 | 32 | 73 | 8 | M10x45 |
| | 6,4 | | 1/4" | AMP.P ₁ 6,4 | MMP.P ₁ 6,4 | RMP.P ₁ 6,4 | AMLL.P ₁ 6,4 | | | | | | | |
| | 8 | | 5/16" | AMP.P ₁ 08 | MMP.P ₁ 08 | RMP.P ₁ 08 | AMLL.P ₁ 08 | | | | | | | |
| | 9,5 | | 3/8" | AMP.P ₁ 9,5 | MMP.P ₁ 9,5 | RMP.P ₁ 9,5 | AMLL.P ₁ 9,5 | | | | | | | |
| | 10 | 1/8" | | AMP.P ₁ 10 | MMP.P ₁ 10 | RMP.P ₁ 10 | AMLL.P ₁ 10 | | | | | | | |
| | 12 | | | AMP.P ₁ 12 | MMP.P ₁ 12 | RMP.P ₁ 12 | AMLL.P ₁ 12 | | | | | | | |
| | 12,7 | | 1/2" | AMP.P ₁ 12,7 | MMP.P ₁ 12,7 | RMP.P ₁ 12,7 | AMLL.P ₁ 12,7 | | | | | | | |
| | 13,5 | 1/4" | | AMP.P ₁ 1/4" | MMP.P ₁ 1/4" | RMP.P ₁ 1/4" | AMLL.P ₁ 1/4" | | | | | | | |
| | 14 | | | AMP.P ₁ 14 | MMP.P ₁ 14 | RMP.P ₁ 14 | AMLL.P ₁ 14 | | | | | | | |
| | 15 | | | AMP.P ₁ 15 | MMP.P ₁ 15 | RMP.P ₁ 15 | AMLL.P ₁ 15 | | | | | | | |
| 2 | 16 | | 5/8" | AMP.P ₁ 16 | MMP.P ₁ 16 | RMP.P ₁ 16 | AMLL.P ₁ 16 | 30 | 70 | 45 | 48 | 85 | 8 | M10x60 |
| | 17,2 | 3/8" | | AMP.P ₁ 3/8" | MMP.P ₁ 3/8" | RMP.P ₁ 3/8" | AMLL.P ₁ 3/8" | | | | | | | |
| | 18 | | | AMP.P ₁ 18 | MMP.P ₁ 18 | RMP.P ₁ 18 | AMLL.P ₁ 18 | | | | | | | |
| | 19 | | 3/4" | AMP.P ₂ 19 | MMP.P ₂ 19 | RMP.P ₂ 19 | AMLL.P ₂ 19 | | | | | | | |
| | 20 | | | AMP.P ₂ 20 | MMP.P ₂ 20 | RMP.P ₂ 20 | AMLL.P ₂ 20 | | | | | | | |
| | 21,3 | 1/2" | | AMP.P ₂ 1/2" | MMP.P ₂ 1/2" | RMP.P ₂ 1/2" | AMLL.P ₂ 1/2" | | | | | | | |
| | 22 | | 7/8" | AMP.P ₂ 22 | MMP.P ₂ 22 | RMP.P ₂ 22 | AMLL.P ₂ 22 | | | | | | | |
| | 25 | | | AMP.P ₂ 25 | MMP.P ₂ 25 | RMP.P ₂ 25 | AMLL.P ₂ 25 | | | | | | | |
| | 25,4 | | 1" | AMP.P ₂ 25,4 | MMP.P ₂ 25,4 | RMP.P ₂ 25,4 | AMLL.P ₂ 25,4 | | | | | | | |
| | 26,9 | 3/4" | | AMP.P ₂ 3/4" | MMP.P ₂ 3/4" | RMP.P ₂ 3/4" | AMLL.P ₂ 3/4" | | | | | | | |
| 3 | 28 | | | AMP.P ₂ 28 | MMP.P ₂ 28 | RMP.P ₂ 28 | AMLL.P ₂ 28 | 30 | 85 | 60 | 60 | 102 | 8 | M10x70 |
| | 30 | | | AMP.P ₂ 30 | MMP.P ₂ 30 | RMP.P ₂ 30 | AMLL.P ₂ 30 | | | | | | | |
| | 30 | | | AMP.P ₃ 30 | MMP.P ₃ 30 | RMP.P ₃ 30 | AMLL.P ₃ 30 | | | | | | | |
| | 32 | | 1 1/4" | AMP.P ₃ 32 | MMP.P ₃ 32 | RMP.P ₃ 32 | AMLL.P ₃ 32 | | | | | | | |
| | 33,7 | 1" | | AMP.P ₃ 1" | MMP.P ₃ 1" | RMP.P ₃ 1" | AMLL.P ₃ 1" | | | | | | | |
| | 35 | | | AMP.P ₃ 35 | MMP.P ₃ 35 | RMP.P ₃ 35 | AMLL.P ₃ 35 | | | | | | | |
| | 38 | | 1 1/2" | AMP.P ₃ 38 | MMP.P ₃ 38 | RMP.P ₃ 38 | AMLL.P ₃ 38 | | | | | | | |
| 4 | 40 | | | AMP.P ₃ 40 | MMP.P ₃ 40 | RMP.P ₃ 40 | AMLL.P ₃ 40 | 45 | 120 | 90 | 90 | 140 | 10 | M12x100 |
| | 42 | | | AMP.P ₃ 42 | MMP.P ₃ 42 | RMP.P ₃ 42 | AMLL.P ₃ 42 | | | | | | | |
| | 42,4 | 1 1/4" | | AMP.P ₃ 1 1/4" | MMP.P ₃ 1 1/4" | RMP.P ₃ 1 1/4" | AMLL.P ₃ 1 1/4" | | | | | | | |
| | 44,5 | | 1 3/4" | AMP.P ₄ 44,5 | MMP.P ₄ 44,5 | RMP.P ₄ 44,5 | AMLL.P ₄ 44,5 | | | | | | | |
| | 48,3 | 1 1/2" | | AMP.P ₄ 1 1/2" | MMP.P ₄ 1 1/2" | RMP.P ₄ 1 1/2" | AMLL.P ₄ 1 1/2" | | | | | | | |
| | 50 | | | AMP.P ₄ 50 | MMP.P ₄ 50 | RMP.P ₄ 50 | AMLL.P ₄ 50 | | | | | | | |
| | 50,8 | | 2" | AMP.P ₄ 50,8 | MMP.P ₄ 50,8 | RMP.P ₄ 50,8 | AMLL.P ₄ 50,8 | | | | | | | |
| | 55 | | | AMP.P ₄ 55 | MMP.P ₄ 55 | RMP.P ₄ 55 | AMLL.P ₄ 55 | | | | | | | |
| | 57 | | 2 1/4" | AMP.P ₄ 57 | MMP.P ₄ 57 | RMP.P ₄ 57 | AMLL.P ₄ 57 | | | | | | | |
| | 60,3 | 2" | | AMP.P ₄ 2" | MMP.P ₄ 2" | RMP.P ₄ 2" | AMLL.P ₄ 2" | | | | | | | |
| 63,5 | | 2 1/2" | AMP.P ₄ 63,5 | MMP.P ₄ 63,5 | RMP.P ₄ 63,5 | AMLL.P ₄ 63,5 | | | | | | | | |
| 65 | | | AMP.P ₄ 65 | MMP.P ₄ 65 | RMP.P ₄ 65 | AMLL.P ₄ 65 | | | | | | | | |
| 70 | | 2 3/4" | AMP.P ₄ 70 | MMP.P ₄ 70 | RMP.P ₄ 70 | AMLL.P ₄ 70 | | | | | | | | |

AMP.P*... = polipropilene / polypropylene
 ...H = interno liscio / smooth inside (per ordine di collari tipo H, aggiungere H dopo il codice / to order clamps type H, please put the H at the end of the code)

MMP.P... = polyamide / self-extinguishing

RMP.P... = gomma / rubber

AMLL.P... = alluminio / aluminium

tipo normale
interno sagomato

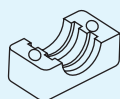

normal model
profiled inside

tipo H
interno liscio

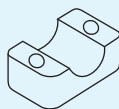

H model
smooth inside

tipo normale
interno sagomato

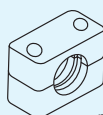

normal model
profiled inside

tipo H
interno liscio

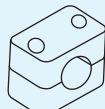

H model
smooth inside

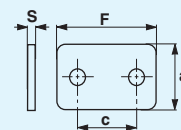
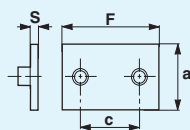

| semi-collare clamp-half | coppia collari clamp body (2 halves) | piastra inferiore lower plate | | | | piastra superiore upper plate | | | |
|-----------------------------|---|----------------------------------|---------|---------|---------|----------------------------------|---------|---------|---------|
| | | APINP | | | | APSP | | | |
| AMP.P ... S | AMP.P ... C | a mm | F mm | c mm | S mm | a mm | F mm | c mm | S mm |
| AMP.P ₁ 06 S | AMP.P ₁ 06 C | APINP₁ | | | | APSP₁ | | | |
| AMP.P ₁ 6,4 S | AMP.P ₁ 6,4 C | 30 | 75 | 33 | 8 | 30 | 55 | 33 | 8 |
| AMP.P ₁ 08 S | AMP.P ₁ 08 C | | | | | | | | |
| AMP.P ₁ 9,5 S | AMP.P ₁ 9,5 C | | | | | | | | |
| AMP.P ₁ 10 S | AMP.P ₁ 10 C | | | | | | | | |
| AMP.P ₁ 12 S | AMP.P ₁ 12 C | | | | | | | | |
| AMP.P ₁ 12,7 S | AMP.P ₁ 12,7 C | | | | | | | | |
| AMP.P ₁ 1/4" S | AMP.P ₁ 1/4" C | | | | | | | | |
| AMP.P ₁ 14 S | AMP.P ₁ 14 C | | | | | | | | |
| AMP.P ₁ 15 S | AMP.P ₁ 15 C | | | | | | | | |
| AMP.P ₁ 16 S | AMP.P ₁ 16 C | | | | | | | | |
| AMP.P ₁ 3/8" S | AMP.P ₁ 3/8" C | | | | | | | | |
| AMP.P ₁ 18 S | AMP.P ₁ 18 C | | | | | | | | |
| AMP.P ₂ 19 S | AMP.P ₂ 19 C | APINP₂ | | | | APSP₂ | | | |
| AMP.P ₂ 20 S | AMP.P ₂ 20 C | 30 | 87 | 45 | 8 | 30 | 70 | 45 | 8 |
| AMP.P ₂ 1/2" S | AMP.P ₂ 1/2" C | | | | | | | | |
| AMP.P ₂ 22 S | AMP.P ₂ 22 C | | | | | | | | |
| AMP.P ₂ 25 S | AMP.P ₂ 25 C | | | | | | | | |
| AMP.P ₂ 25,4 S | AMP.P ₂ 25,4 C | | | | | | | | |
| AMP.P ₂ 3/4" S | AMP.P ₂ 3/4" C | | | | | | | | |
| AMP.P ₂ 28 S | AMP.P ₂ 28 C | | | | | | | | |
| AMP.P ₂ 30 S | AMP.P ₂ 30 C | | | | | | | | |
| AMP.P ₃ 30 S | AMP.P ₃ 30 C | APINP₃ | | | | APSP₃ | | | |
| AMP.P ₃ 32 S | AMP.P ₃ 32 C | 30 | 102 | 60 | 8 | 30 | 85 | 60 | 8 |
| AMP.P ₃ 1" S | AMP.P ₃ 1" C | | | | | | | | |
| AMP.P ₃ 35 S | AMP.P ₃ 35 C | | | | | | | | |
| AMP.P ₃ 38 S | AMP.P ₃ 38 C | | | | | | | | |
| AMP.P ₃ 40 S | AMP.P ₃ 40 C | | | | | | | | |
| AMP.P ₃ 42 S | AMP.P ₃ 42 C | | | | | | | | |
| AMP.P ₃ 1 1/4" S | AMP.P ₃ 1 1/4" C | | | | | | | | |
| AMP.P ₄ 38 S | AMP.P ₄ 38 C | APINP₄ | | | | APSP₄ | | | |
| AMP.P ₄ 42 S | AMP.P ₄ 42 C | 45 | 140 | 90 | 10 | 45 | 120 | 90 | 10 |
| AMP.P ₄ 1 1/4" S | AMP.P ₄ 1 1/4" C | | | | | | | | |
| AMP.P ₄ 44,5 S | AMP.P ₄ 44,5 C | | | | | | | | |
| AMP.P ₄ 1 1/2" S | AMP.P ₄ 1 1/2" C | | | | | | | | |
| AMP.P ₄ 50 S | AMP.P ₄ 50 C | | | | | | | | |
| AMP.P ₄ 50,8 S | AMP.P ₄ 50,8 C | | | | | | | | |
| AMP.P ₄ 55 S | AMP.P ₄ 55 C | | | | | | | | |
| AMP.P ₄ 57 S | AMP.P ₄ 57 C | | | | | | | | |
| AMP.P ₄ 2" S | AMP.P ₄ 2" C | | | | | | | | |
| AMP.P ₄ 63,5 S | AMP.P ₄ 63,5 C | | | | | | | | |
| AMP.P ₄ 65 S | AMP.P ₄ 65 C | | | | | | | | |
| AMP.P ₄ 70 S | AMP.P ₄ 70 C | | | | | | | | |

* La produzione standard è di colore verde, colore nero su richiesta.
 Standard production in green, black color on request.

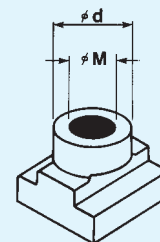
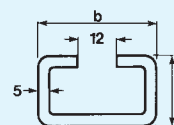
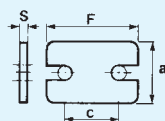
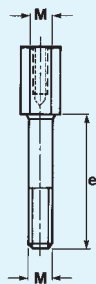

| vite a testa esagonale hexagonal head screw | vite a testa esagonale allungata high hexagonal head screw | piastra superiore di sicurezza security upper plate | | | | binari portanti spessore 5 mm rail | | dado fissaggio binari rail nut | | | |
|--|--|--|---------|---------|---------|--|---------|-----------------------------------|---------|----|-----------|
| AVTEP | AVTEAP | APMRSP | | | | ABINP | | ADESP | | | |
| M | e mm | M | e mm | a mm | F mm | c mm | S mm | b mm | h mm | M | Ø d mm |
| AVTEP₁ | AVTEAP₁ | APMRSP₁ | | | | ABINP-1 | | ADESP-1 | | | |
| M10 | 45 | M10 | 26 | 30 | 55 | | | | | 33 | 8 |
| AVTEP₂ | AVTEAP₂ | APMRSP₂ | | | | | | | | | |
| M10 | 60 | M10 | 41 | 30 | 70 | | | | | 45 | 8 |
| AVTEP₃ | AVTEAP₃ | APMRSP₃ | | | | ABINP-1 | | ADESP-1 | | | |
| M10 | 70 | M10 | 52 | 30 | 85 | | | | | 60 | 8 |
| AVTEP₄ | AVTEAP₄ | APMRSP₄ | | | | ABINP-1 | | ADESP-2 | | | |
| M12 | 100 | M12 | 83 | 45 | 120 | | | | | 90 | 10 |

* Altre piastre speciali sono a pag. 19
Other special plate are at page 19

**Collari serie pesante
in polipropilene,
poliammide autoestinguente,
alluminio o gomma**

**Heavy duty clamps
in polypropylene,
self-extinguishing polyamide,
aluminium or rubber**

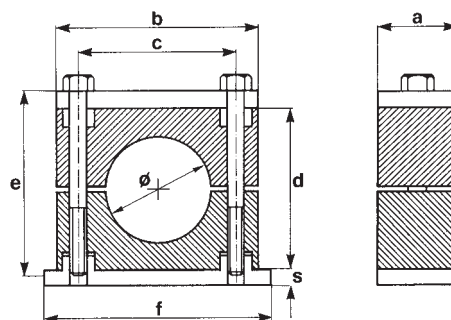

| gruppo - group | diametro tubo pipe diameter | | | tipo di collare clamp type | | | | dimensioni in mm dimension in mm | | | | | | |
|----------------|--------------------------------|---------------------------------|---------------------------------|--|--|--|---|-------------------------------------|-----|-----|-----|-----|----|---------|
| | ϕ mm | pollici/inches G | ϕ O.D. | AMP.P polipropilene polypropylene | MMP.P polyamide self-extinguishing | RMP.P gomma rubber | AMLL.P alluminio aluminium | a | b | c | d | f | s | e |
| 5 | 65 | | | AMP.P ₅ 65 | MMP.P ₅ 65 | RMP.P ₅ 65 | AMLL.P ₅ 65 | 60 | 152 | 122 | 120 | 180 | 10 | M16x130 |
| | 70 | | 2 ³ / ₄ " | AMP.P ₅ 70 | MMP.P ₅ 70 | RMP.P ₅ 70 | AMLL.P ₅ 70 | | | | | | | |
| | 75 | | | AMP.P ₅ 75 | MMP.P ₅ 75 | RMP.P ₅ 75 | AMLL.P ₅ 75 | | | | | | | |
| | 76,1 | 2 ¹ / ₂ " | 3" | AMP.P ₅ 2 ¹ / ₂ " | MMP.P ₅ 2 ¹ / ₂ " | RMP.P ₅ 2 ¹ / ₂ " | AMLL.P ₅ 2 ¹ / ₂ " | | | | | | | |
| | 80 | | | AMP.P ₅ 80 | MMP.P ₅ 80 | RMP.P ₅ 80 | AMLL.P ₅ 80 | | | | | | | |
| | 82,5 | | 3 ¹ / ₄ " | AMP.P ₅ 82,5 | MMP.P ₅ 82,5 | RMP.P ₅ 82,5 | AMLL.P ₅ 82,5 | | | | | | | |
| | 88,9 | 3" | 3 ¹ / ₂ " | AMP.P ₅ 3" | MMP.P ₅ 3" | RMP.P ₅ 3" | AMLL.P ₅ 3" | | | | | | | |
| 6 | 88,9 | 3" | 3 ¹ / ₂ " | AMP.P ₆ 3" | MMP.P ₆ 3" | RMP.P ₆ 3" | — | 80 | 205 | 168 | 170 | 225 | 15 | M20x190 |
| | 100 | | | AMP.P ₆ 100 | MMP.P ₆ 100 | RMP.P ₆ 100 | — | | | | | | | |
| | 101,6 | 3 ¹ / ₂ " | 4" | AMP.P ₆ 3 ¹ / ₂ " | MMP.P ₆ 3 ¹ / ₂ " | RMP.P ₆ 3 ¹ / ₂ " | — | | | | | | | |
| | 108 | | 4 ¹ / ₄ " | AMP.P ₆ 108 | MMP.P ₆ 108 | RMP.P ₆ 108 | — | | | | | | | |
| | 114,3 | 4" | 4 ¹ / ₂ " | AMP.P ₆ 4" | MMP.P ₆ 4" | RMP.P ₆ 4" | — | | | | | | | |
| | 127 | 4 ¹ / ₂ " | 5" | AMP.P ₆ 4 ¹ / ₂ " | MMP.P ₆ 4 ¹ / ₂ " | RMP.P ₆ 4 ¹ / ₂ " | — | | | | | | | |
| | 133 | | 5 ¹ / ₂ " | AMP.P ₆ 133 | MMP.P ₆ 133 | RMP.P ₆ 133 | — | | | | | | | |
| 7 | 133 | | 5 ¹ / ₄ " | AMP.P ₇ 133 | MMP.P ₇ 133 | RMP.P ₇ 133 | — | 90 | 250 | 205 | 200 | 270 | 15 | M24x220 |
| | 139,7 | 5" | 5 ¹ / ₂ " | AMP.P ₇ 5" | MMP.P ₇ 5" | RMP.P ₇ 5" | — | | | | | | | |
| | 152,4 | 5 ¹ / ₂ " | 6" | AMP.P ₇ 5 ¹ / ₂ " | MMP.P ₇ 5 ¹ / ₂ " | RMP.P ₇ 5 ¹ / ₂ " | — | | | | | | | |
| | 165 | | 6 ¹ / ₂ " | AMP.P ₇ 165 | MMP.P ₇ 165 | RMP.P ₇ 165 | — | | | | | | | |
| | 168,3 | 6" | | AMP.P ₇ 6" | MMP.P ₇ 6" | RMP.P ₇ 6" | — | | | | | | | |
| 8 | 168,3 | 6" | | AMP.P ₈ 6" | — | — | — | 120 | 320 | 265 | 270 | 340 | 25 | M30x300 |
| | 177,8 | | 7" | AMP.P ₈ 177,8 | — | — | — | | | | | | | |
| | 193,7 | | 7 ⁵ / ₈ " | AMP.P ₈ 193,7 | — | — | — | | | | | | | |
| | 216 | | 8 ¹ / ₂ " | AMP.P ₈ 216 | — | — | — | | | | | | | |
| | 219,1 | 8" | | AMP.P ₈ 8" | — | — | — | | | | | | | |

AMP.P*... = polipropilene / polypropylene MMP.P... = polyamide / self-extinguishing RMP.P... = gomma / rubber AMLL.P... = alluminio / aluminium
 ...H = interno liscio / smooth inside (per ordine di collari tipo H, aggiungere H dopo il codice / to order clamps type H, please put the H at the end of the code)

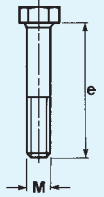
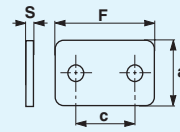
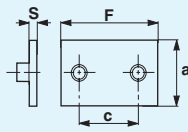
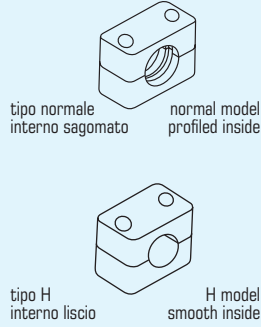
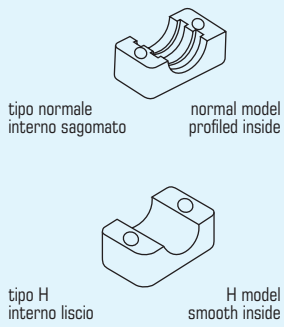

| semi-collare clamp-half | coppia collari clamp body (2 halves) | piastra inferiore lower plate | | | | piastra superiore upper plate | | | | vite a testa esagonale hexagonal head screw | |
|-----------------------------|---|----------------------------------|---------|---------|---------|----------------------------------|---------|---------|---------|--|---------|
| | | APINP | | | | APSP | | | | AVTEP | |
| AMP.P ... S | AMP.P ... C | a mm | F mm | c mm | S mm | a mm | F mm | c mm | S mm | M | e mm |
| | | APINP₅ | | | | APSP₅ | | | | AVTEP₅ | |
| AMP.P ₅ 65 S | AMP.P ₅ 65 C | 60 | 180 | 122 | 10 | 60 | 152 | 122 | 10 | M16 | 130 |
| AMP.P ₅ 70 S | AMP.P ₅ 70 C | | | | | | | | | | |
| AMP.P ₅ 75 S | AMP.P ₅ 75 C | | | | | | | | | | |
| AMP.P ₅ 2 1/2" S | AMP.P ₅ 2 1/2" C | | | | | | | | | | |
| AMP.P ₅ 80 S | AMP.P ₅ 80 C | | | | | | | | | | |
| AMP.P ₅ 82,5 S | AMP.P ₅ 82,5 C | | | | | | | | | | |
| AMP.P ₅ 3" S | AMP.P ₅ 3" C | | | | | | | | | | |
| | | APINP₆ | | | | APSP₆ | | | | AVTEP₆ | |
| AMP.P ₆ 3" S | AMP.P ₆ 3" C | 80 | 225 | 168 | 15 | 80 | 205 | 168 | 15 | M20 | 190 |
| AMP.P ₆ 100 S | AMP.P ₆ 100 C | | | | | | | | | | |
| AMP.P ₆ 3 1/2" S | AMP.P ₆ 3 1/2" C | | | | | | | | | | |
| AMP.P ₆ 108 S | AMP.P ₆ 108 C | | | | | | | | | | |
| AMP.P ₆ 4" S | AMP.P ₆ 4" C | | | | | | | | | | |
| AMP.P ₆ 4 1/2" S | AMP.P ₆ 4 1/2" C | | | | | | | | | | |
| AMP.P ₆ 133 S | AMP.P ₆ 133 C | | | | | | | | | | |
| | | APINP₇ | | | | APSP₇ | | | | AVTEP₇ | |
| AMP.P ₇ 133 S | AMP.P ₇ 133 C | 90 | 270 | 205 | 15 | 90 | 250 | 205 | 15 | M24 | 220 |
| AMP.P ₇ 5" S | AMP.P ₇ 5" C | | | | | | | | | | |
| AMP.P ₇ 5 1/2" S | AMP.P ₇ 5 1/2" C | | | | | | | | | | |
| AMP.P ₇ 165 S | AMP.P ₇ 165 C | | | | | | | | | | |
| AMP.P ₇ 6" S | AMP.P ₇ 6" C | | | | | | | | | | |
| | | APINP₈ | | | | APSP₈ | | | | AVTEP₈ | |
| AMP.P ₈ 6" S | AMP.P ₈ 6" C | 120 | 340 | 265 | 25 | 120 | 320 | 265 | 25 | M30 | 300 |
| AMP.P ₈ 177,8 S | AMP.P ₈ 177,8 C | | | | | | | | | | |
| AMP.P ₈ 193,7 S | AMP.P ₈ 193,7 C | | | | | | | | | | |
| AMP.P ₈ 216 S | AMP.P ₈ 216 C | | | | | | | | | | |
| AMP.P ₈ 8" S | AMP.P ₈ 8" C | | | | | | | | | | |

* La produzione standard è di colore verde, colore nero su richiesta.
 Standard production in green, black color on request.

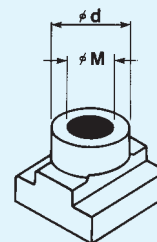
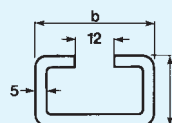
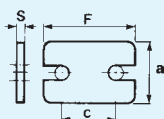
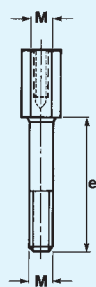

| vite a testa esagonale allungata high hexagonal head screw | piastra superiore di sicurezza security upper plate | | | | binari portanti spessore 5 mm rail | dado fissaggio binari rail nut |
|---|--|---------|---------|---------|---------------------------------------|-----------------------------------|
| AVTEAP | APMRSP | | | | ABINP | ADESP |
| M e mm | a mm | F mm | c mm | S mm | b mm h mm | M Ø d mm |
| AVTEAP₅ | APMRSP₅ | | | | | |
| M16 110 | 60 | 152 | 122 | 10 | 40 22 | M16 20 |

Piastre doppie per serie pesante Double plates for heavy duty series

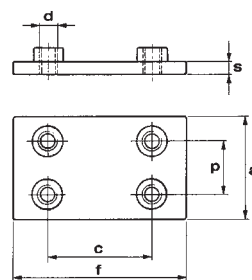
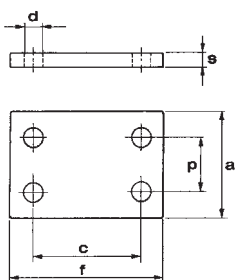

| gruppo - group | piastra superiore doppia double upper plate | | | | | |
|----------------|--|---------|---------|---------|---------|---------|
| | APSPD | | | | | |
| | a mm | f mm | s mm | c mm | p mm | d mm |
| 1 | APSPD₁ | | | | | |
| | 60 | 56 | 8 | 33 | 31 | 11 |
| 2 | APSPD₂ | | | | | |
| | 60 | 70 | 8 | 45 | 31 | 11 |
| 3 | APSPD₃ | | | | | |
| | 60 | 85 | 8 | 60 | 31 | 11 |
| 4 | APSPD₄ | | | | | |
| | 90 | 116 | 10 | 90 | 46 | 14 |
| 5 | APSPD₅ | | | | | |
| | 120 | 153 | 10 | 122 | 61 | 18 |

| gruppo - group | piastra inferiore doppia double lower plate | | | | | |
|----------------|--|---------|---------|---------|---------|-----|
| | APINPD | | | | | |
| | a mm | f mm | s mm | c mm | p mm | m |
| 1 | APINPD₁ | | | | | |
| | 60 | 74 | 8 | 33 | 31 | M10 |
| 2 | APINPD₂ | | | | | |
| | 60 | 86 | 8 | 45 | 31 | M10 |
| 3 | APINPD₃ | | | | | |
| | 60 | 100 | 8 | 60 | 31 | M10 |
| 4 | APINPD₄ | | | | | |
| | 90 | 140 | 10 | 90 | 46 | M12 |
| 5 | APINPD₅ | | | | | |
| | 120 | 180 | 10 | 122 | 61 | M16 |

**Collari doppi serie pesante
in polipropilene o poliammide
autoestinguente**

**Heavy duty double clamps
in polypropylene and
self-extinguishing polyamid**

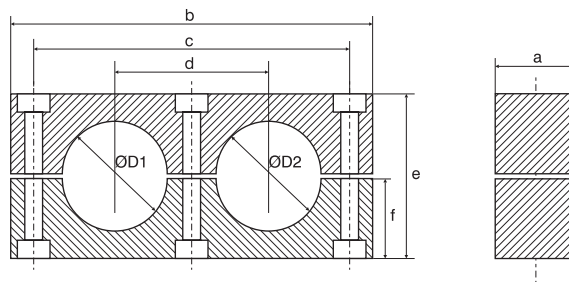

| gruppo - group | diametro tubo pipe diameter | | tipo di collare clamp type | | dimensioni in mm dimension in mm | | | | | |
|----------------|--------------------------------|------------------------------|--|---|-------------------------------------|-----|-----|----|----|----|
| | ØD1/ØD2 mm | pollici/inches G Ø | AMD.P polipropilene polypropylene | MMD.P polyamide self-extinguishing | a | b | c | d | e | f |
| 4 | 19/19 | 3/4 / 3/4 | AMD.P ₄ 19/19 | MMD.P ₄ 19/19 | 30 | 115 | 90 | 45 | 48 | 24 |
| | 20/20 | | AMD.P ₄ 20/20 | MMD.P ₄ 20/20 | | | | | | |
| | 21,3/21,3 | 1/2 / 1/2 | AMD.P ₄ 21,3/21,3 | MMD.P ₄ 21,3/21,3 | | | | | | |
| | 22/22 | 7/8 / 7/8 | AMD.P ₄ 22/22 | MMD.P ₄ 22/22 | | | | | | |
| | 25,4/25,4 | | AMD.P ₄ 25,4/25,4 | MMD.P ₄ 25,4/25,4 | | | | | | |
| 26,9/26,9 | 3/4 / 3/4 | AMD.P ₄ 26,9/26,9 | MMD.P ₄ 26,9/26,9 | | | | | | | |
| 5 | 32/32 | 3" / 3 1/2" | AMD.P ₅ 32/32 | MMD.P ₅ 32/32 | 30 | 144 | 120 | 60 | 60 | 30 |
| | 33,7/33,7 | | AMD.P ₅ 33,7/33,7 | MMD.P ₅ 33,7/33,7 | | | | | | |
| | 38/38 | 3 1/2" / 4" | AMD.P ₅ 38/38 | MMD.P ₅ 38/38 | | | | | | |
| | 40/40 | 4 1/4" | AMD.P ₅ 40/40 | MMD.P ₅ 40/40 | | | | | | |
| | 42/42 | 4" / 4 1/2" | AMD.P ₅ 42/42 | MMD.P ₅ 42/42 | | | | | | |

| coppia collare clamp body (2 halves) | | piastra inferiore lower plate | | | | | piastra superiore cover plate | | | | | vite a testa esagonale hexagonal head screw | | | |
|--|---|----------------------------------|---------------------------|-----|----|---|----------------------------------|--------------------------|-----|----|---|--|--------------------------|-----|----|
| AMD.P polipropilene polypropylene | MMD.P polyamide self-extinguishing | APINDP | | | | | APSDP | | | | | AVTDP | | | |
| | | 2c | ø m | Ø D | s | f | a | 2c | ø m | s | b | a | M | e | |
| 4 | AMD.P ₄ 19/19 C | MMD.P ₄ 19/19 C | APINDP₄ | | | | | APSDP₄ | | | | | AVTDP₄ | | |
| | AMD.P ₄ 20/20 C | MMD.P ₄ 20/20 C | 90 | 10 | 18 | 8 | 130 | 30 | 90 | 11 | 8 | 115 | 30 | M10 | 60 |
| | AMD.P ₄ 21,3/21,3 C | MMD.P ₄ 21,3/21,3 C | | | | | | | | | | | | | |
| | AMD.P ₄ 22/22 C | MMD.P ₄ 22/22 C | | | | | | | | | | | | | |
| | AMD.P ₄ 25,4/25,4 C | MMD.P ₄ 25,4/25,4 C | | | | | | | | | | | | | |
| AMD.P ₄ 26,9/26,9 C | MMD.P ₄ 26,9/26,9 C | | | | | | | | | | | | | | |
| 5 | AMD.P ₅ 32/32 C | MMD.P ₅ 32/32 C | APINDP₅ | | | | | APSDP₅ | | | | | AVTDP₅ | | |
| | AMD.P ₅ 33,7/33,7 C | MMD.P ₅ 33,7/33,7 C | 120 | 10 | 18 | 8 | 160 | 30 | 120 | 11 | 8 | 144 | 30 | M10 | 70 |
| | AMD.P ₅ 38/38 C | MMD.P ₅ 38/38 C | | | | | | | | | | | | | |
| | AMD.P ₅ 40/40 C | MMD.P ₅ 40/40 C | | | | | | | | | | | | | |
| | AMD.P ₅ 42/42 C | MMD.P ₅ 42/42 C | | | | | | | | | | | | | |

* La produzione standard è di colore verde, colore nero su richiesta. / Standard production in green, black color on request.

Piastre speciali per serie standard

Special plates for standard series

gruppo
group

0

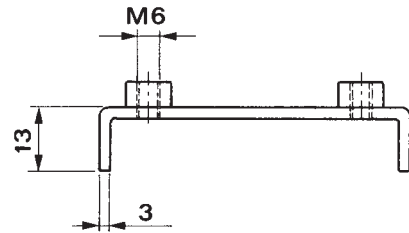
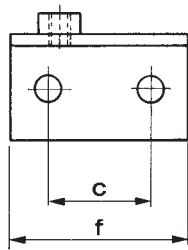

gruppo
group

1÷6

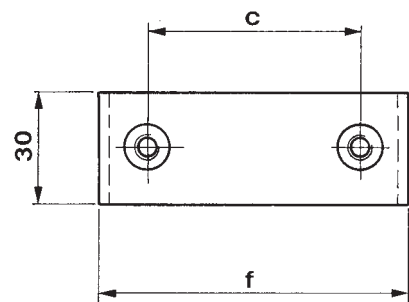
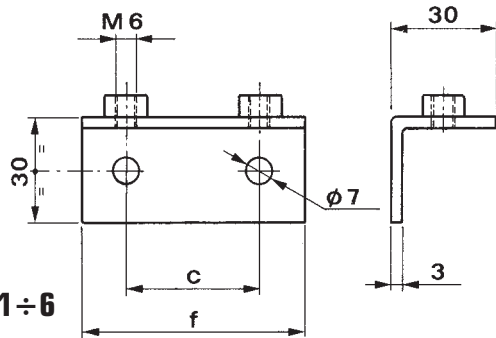

| gruppo - group | piastra ad angolo angled plate | |
|----------------|-----------------------------------|---------|
| | c mm | f mm |
| 0 | APINL₀ | |
| | 14 | 32 |
| 1 | APINL₁ | |
| | 20 | 42 |
| 2 | APINL₂ | |
| | 26 | 48 |
| 3 | APINL₃ | |
| | 33 | 55 |
| 4 | APINL₄ | |
| | 40 | 62 |
| 5 | APINL₅ | |
| | 52 | 74 |
| 6 | APINL₆ | |
| | 66 | 88 |

| gruppo - group | piastra a ponte bridge plate | |
|----------------|---------------------------------|---------|
| | c mm | f mm |
| 0 | APINB₀ | |
| | — | — |
| 1 | APINB₁ | |
| | 20 | 48 |
| 2 | APINB₂ | |
| | 26 | 54 |
| 3 | APINB₃ | |
| | 33 | 62 |
| 4 | APINB₄ | |
| | 40 | 71 |
| 5 | APINB₅ | |
| | 52 | 85 |
| 6 | APINB₆ | |
| | 66 | 98 |

Collari serie standard per tubi gemellati

Standard series clamps for twin tubes

- A:** senza piastra superiore
without upper plate
- B:** con piastra superiore (a richiesta)
with upper plate (on request)

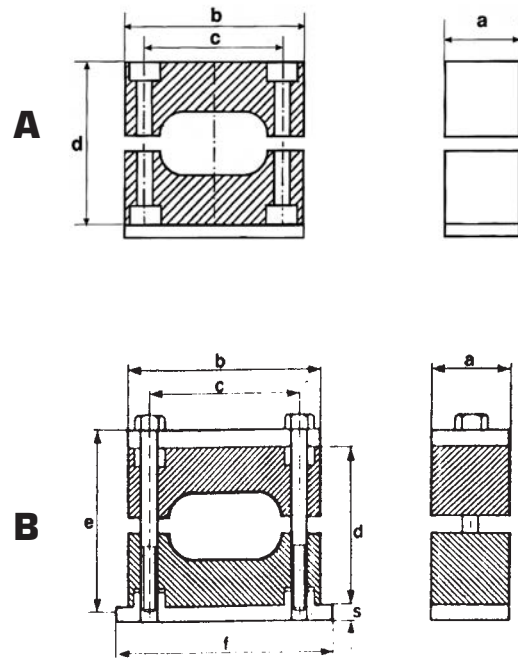

| diametro tubo pipe diameter | | tipo di collare clamp type | | | dimensioni in mm dimension in mm | | | | |
|--------------------------------|-------------------|--------------------------------|---------------------------------|-------------------|-------------------------------------|----|----|----|---------------|
| mm | pollici inches | polipropilene polypropylene | polyamide self-extinguishing | gomma rubber | a | b | c | d | viti screw |
| 12 | 1/4 | TBP 3 1/4 | TBM 3 1/4 | TBR 3 1/4 | 30 | 48 | 33 | 35 | M6 x 30 |
| 14 | 5/16 | TBP 4 5/16 | TBM 4 5/16 | TBR 4 5/16 | 30 | 52 | 40 | 42 | M6 x 35 |
| 16 | 3/8 | TBP 4 3/8 | TBM 4 3/8 | TBR 4 3/8 | 30 | 52 | 40 | 42 | M6 x 35 |
| 20 | 1/2 | TBP 5 1/2 | TBM 5 1/2 | TBR 5 1/2 | 30 | 68 | 52 | 58 | M6 x 50 |

Elementi di fissaggio per tubi rigidi, flessibili e cavi elettrici

Clamps for hoses, pipes, tubes and cables

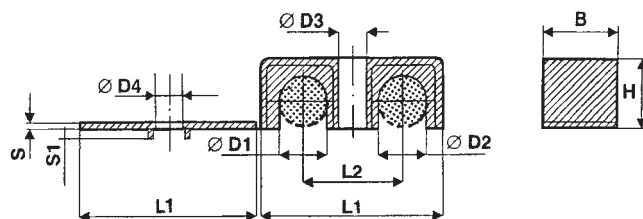

| gruppo - group | diametro tubo D1 - D2 D1 - D2 pipe diameter | | tipo collare clamp type | dimensioni in mm dimensions in mm | | | | | | | | | | colore colour |
|----------------|--|--------------------------------|---|--------------------------------------|----|----|------|---|----|----|----|-----|----|--|
| | Ø mm | pollici inches Ø O.D. | ACSD polipropilene polypropylene | L1 | L2 | B | H | S | S1 | D1 | D2 | D3 | D4 | |
| 2 | 06 - 06 | 1/4 - 1/4 | ACSD 06 - 06 | 38 | 22 | 16 | 14,2 | 2 | 3 | 6 | 6 | 6,9 | 7 | bianco nero verde |
| | 08 - 08 | 1/4 - 1/4 | ACSD 08 - 08 | | | | | | | | | | | white black green |
| | 10 - 10 | 3/8 - 3/8 | ACSD 10 - 10 | 38 | 22 | 16 | 14,5 | 2 | 3 | 10 | 10 | 6,9 | 7 | bianco nero verde |
| | 12 - 12 | 3/8 - 3/8 | ACSD 12 - 12 | | | | | | | | | | | white black green |
| 3 | 15 - 15 | 5/8 - 5/8 | ACSD 15 - 15 | 53 | 31 | 20 | 22,5 | 2 | 3 | 15 | 15 | 6,9 | 7 | bianco nero verde white black green |
| 4 | 19 - 19 | 3/4 - 3/4 | ACSD 19 - 19 | 70 | 38 | 20 | 30 | 2 | 3 | 19 | 19 | 6,9 | 7 | bianco nero verde white black green |

Applicazioni: Oleodinamica e pneumatica, Strumentazione, Tecnologia automobilistica, Industria Macchine Utensili, Macchine per plastica, Macchine movimento terra, Macchine agricole, Lubrificazione, Ingegneria meccanica, ecc.,.

Applications: Oleodynamics and pneumatics, Instrumentation and Automotive Technology, Machine Tool Industry, Gooseneck machines, Earth moving machines, Farm machines, Lubrification, Mechanical Engineering, and so on.

Supporto tra tubo e cilindro
Pipe clamp for cylinder
materiale - material: PVC
△ Shore = 60°C - 284°F

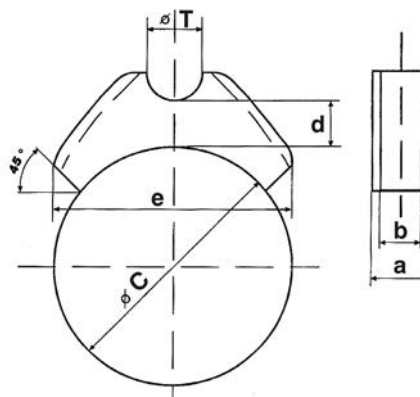

| gruppo - group | codice code | Ø cilindro C - Ø cylinder C | | Ø tubo T - Ø tube T | | dimensioni in mm dimensions in mm | | | |
|----------------|----------------|-----------------------------|-------------|---------------------|-----------|--------------------------------------|----|----|----|
| | | mm | inc. O.D. | mm | inc. O.D. | a | b | d | e |
| 1 | STF 12/50-70 | 50 ÷ 70 | 1,96 ÷ 2,75 | 12 | 0,47 | 23 | 14 | 12 | 72 |
| | STF 12/60-80 | 60 ÷ 80 | 2,36 ÷ 3,15 | | | | | | |
| | STF 12/70-90 | 70 ÷ 90 | 2,75 ÷ 3,54 | | | | | | |
| | STF 12/80-100 | 80 ÷ 100 | 3,15 ÷ 3,94 | | | | | | |
| | STF 12/90-110 | 90 ÷ 110 | 3,54 ÷ 4,33 | | | | | | |
| | STF 12/100-120 | 100 ÷ 120 | 3,94 ÷ 4,72 | | | | | | |
| | STF 12/110-130 | 110 ÷ 130 | 4,33 ÷ 5,12 | | | | | | |
| | STF 12/125-150 | 125 ÷ 150 | 4,92 ÷ 5,90 | | | | | | |
| | STF 12/145-170 | 145 ÷ 170 | 5,71 ÷ 6,69 | | | | | | |
| | STF 12/165-200 | 165 ÷ 200 | 6,49 ÷ 7,87 | | | | | | |
| 2 | STF 20/50-70 | 50 ÷ 70 | 1,96 ÷ 2,75 | 20 | 0,78 | 23 | 14 | 12 | 72 |
| | STF 20/60-80 | 60 ÷ 80 | 2,36 ÷ 3,15 | | | | | | |
| | STF 20/70-90 | 70 ÷ 90 | 2,75 ÷ 3,54 | | | | | | |
| | STF 20/80-100 | 80 ÷ 100 | 3,15 ÷ 3,94 | | | | | | |
| | STF 20/90-110 | 90 ÷ 110 | 3,54 ÷ 4,33 | | | | | | |
| | STF 20/100-120 | 100 ÷ 120 | 3,94 ÷ 4,72 | | | | | | |
| | STF 20/110-130 | 110 ÷ 130 | 4,33 ÷ 5,12 | | | | | | |
| | STF 20/125-150 | 125 ÷ 150 | 4,92 ÷ 5,90 | | | | | | |
| | STF 20/145-170 | 145 ÷ 170 | 5,71 ÷ 6,69 | | | | | | |
| | STF 20/165-200 | 165 ÷ 200 | 6,49 ÷ 7,87 | | | | | | |
| 3 | STF 25/50-70 | 50 ÷ 70 | 1,96 ÷ 2,75 | 25 | 0,98 | 23 | 14 | 12 | 72 |
| | STF 25/60-80 | 60 ÷ 80 | 2,36 ÷ 3,15 | | | | | | |
| | STF 25/70-90 | 70 ÷ 90 | 2,75 ÷ 3,54 | | | | | | |
| | STF 25/80-100 | 80 ÷ 100 | 3,15 ÷ 3,94 | | | | | | |
| | STF 25/90-110 | 90 ÷ 110 | 3,54 ÷ 4,33 | | | | | | |
| | STF 25/100-120 | 100 ÷ 120 | 3,94 ÷ 4,72 | | | | | | |
| | STF 25/110-130 | 110 ÷ 130 | 4,33 ÷ 5,12 | | | | | | |
| | STF 25/125-150 | 125 ÷ 150 | 4,92 ÷ 5,90 | | | | | | |
| | STF 25/145-170 | 145 ÷ 170 | 5,71 ÷ 6,69 | | | | | | |
| | STF 25/165-200 | 165 ÷ 200 | 6,49 ÷ 7,87 | | | | | | |

Applicazioni: Oleodinamica e pneumatica - Macchine utensili - Macchine movimento terra - Macchine agricole - Industria meccanica - Industria in generale - ecc.

Applications: oleodynamic and pneumatic - Machines tools - Earth-moving machines - Farm machines - Mechanical and metallurgical industry - Oil industry - and so on.

Caratteristiche materiali

Materials properties

| | Metodo di prova Test method | Unità di misura Units | Polipropilene Copolimero Metaphasic Copolymers | Poliamide 6-6 Polyamide 6-6 | Gomma termoplastica Thermoplastic Rubber | Alluminio Aluminium |
|---|--------------------------------|--------------------------|---|--|---|--|
| FISICHE Physical | | | | | | |
| Peso specifico Specific gravity | ASTM D 792 | g/cm ³ | 0,9 | 1,34 | 0,964 | |
| Assorbimento d'acqua (24h a 23°C in immersione) Water absorption (24h at 23°C immersion) | ASTM D 570 | % | | 1 | | |
| Ritiro lineare allo stampaggio Mould shrinkage | ASTM D 955 | % | 1,5 ÷ 2,4 | 0,2 ÷ 0,5 | 0,4 ÷ 0,8 | |
| MECCANICHE Mechanical | | | | | | |
| Carico di snervamento a trazione Tensile strenght at yield | ASTM D 638 | N/mm ² | 27 | | | |
| Carico di rottura a trazione Tensile strenght | ASTM D 638 | N/mm ² | | 150 | 1400 | 170 ÷ 220 |
| Modulo elastico a trazione Tensile modulus | ASTM D 638 | N/mm ² | 1400 | 8200 | 530 | 68000 ÷ 78000 |
| Allungamento alla rottura Ultimate elongation | ASTM D 638 | % | 12 | 3 | 750 | |
| Resistenza all'urto con intaglio IZOD 6.4 mm IZOD impact strenght notched 6.4 mm | ASTM D 256 | J/m | 85 | 70 | 71 SHORE A | |
| Durezza Rockwell, scala R + L Rockwell hardness, scale R + L | ASTM D 785 | — | R84 | (L) 150 | | |
| TERMICHE Thermal | | | | | | |
| Temperatura di inflessione 1.82 N mm2 H.D.T. - heat distorsion temperature 1.82 N mm2 | ASTM D 648 | °C | 88 | 240 | 70 ÷ 90 | |
| Temperatura di fusione Melting point | ASTM D 789 | °C | 150 | 258 | | 380 |
| Coefficiente di espansione termico lineare Coefficient of linear thermal expansion | ASTM D 696 | °C | | 2,5 - 10 ⁵ | | 24 - 10 ⁻⁵ (1,6mm: nero/black) |
| Autoestinguenza Flammability | UL 94 | — | | V-0  (1,6mm: nero/black) | | |
| Temperatura max. d'esercizio Max. exercise temperature | — | °C | -30 +90 | -40 +180 | -40 +80 | +350 |
| ELETTRICHE Electrical | | | | | | |
| Rigidità dielettrica - spessore 3 mm Dielectric strenght - thickness 3 mm | ASTM D 149 | kV/mm | | 20 | | 20 |
| Costante dielettrica a 1 kHz Dielectric constant, 1kHz | ASTM D 150 | — | | 4,5 | | |
| Resistività di volume Volume resistivity | ASTM D 257 | Phm. cm ² | 10 ¹⁸ | 4,5 - 10 ¹⁵ | | 4,5 - 10 ¹⁵ |
| Fattore di dissipazione a 1 kHz Dissipation factor, 1 kHz | DIN 53483 | — | | 0,018 | | |
| Resistenza alle correnti striscianti KA sol. A Tracking resistance KA sol. A | DIN 53480 | — | 3C | KA 3b | KA 3b | KA 3b |
| Resistenza alle correnti striscianti KB sol. A Tracking resistance KB sol. A | DIN 53480 | V | > 680 | 450 | | |
| Resistenza alle correnti striscianti KC sol. F Tracking resistance KC sol. F | DIN 53480 | V | > 600 | 450 | | 450 |

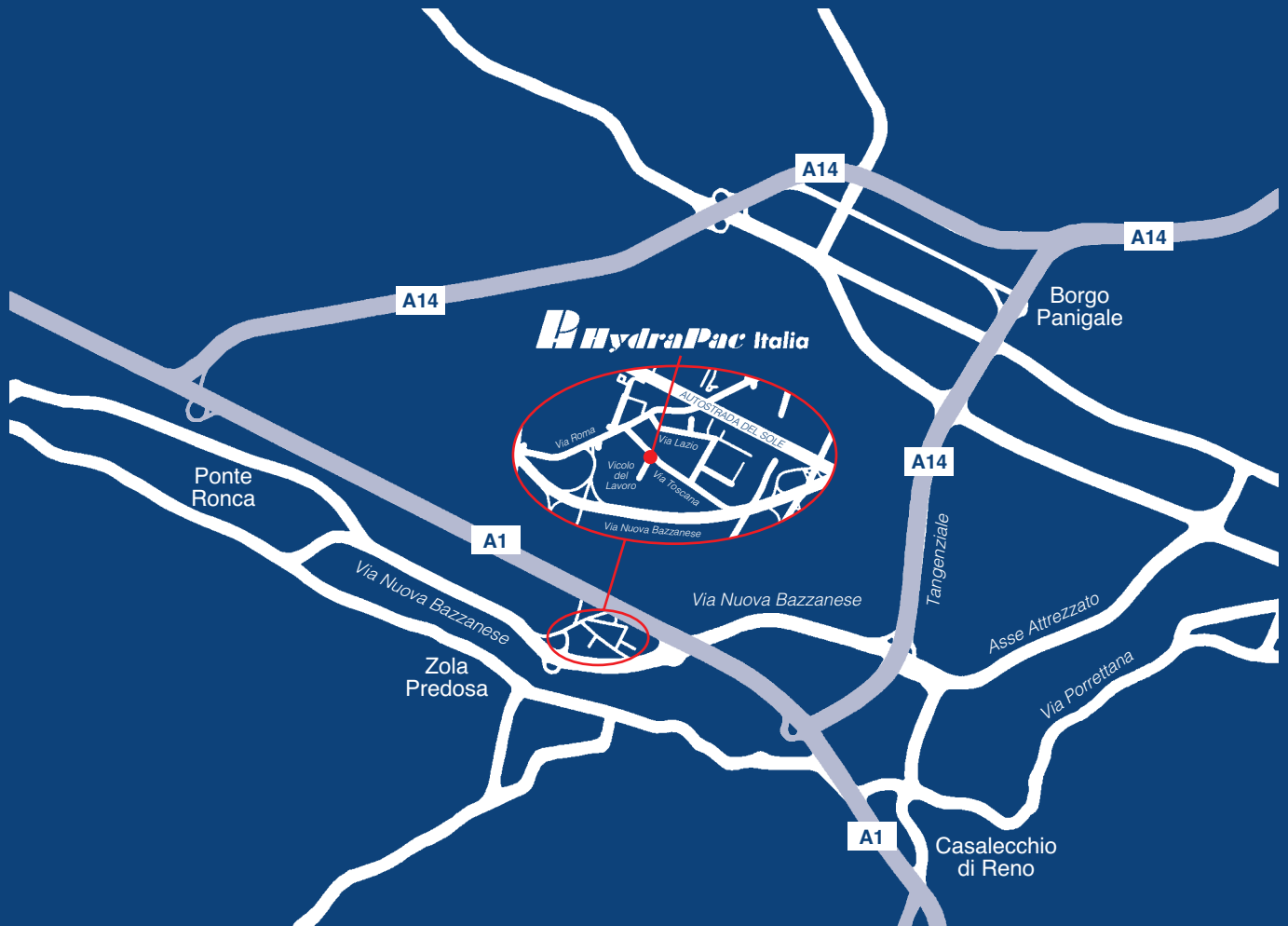

HYDRAPAC ITALIA

Vicolo Del Lavoro, 9 - 40069 Zola Predosa (Bologna) Italy

Tel. +39 051 755082 • Fax +39 051 6185568

www.hydrapac.it • info@hydrapac.it