

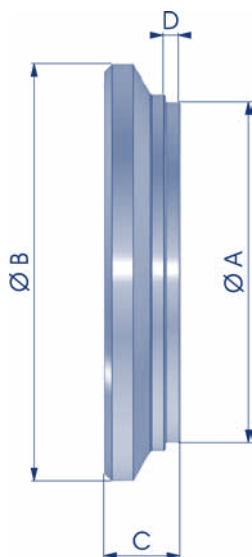

**FONDELLO**  
**END PLUG ZYLINDERBODEN**  
**FOND FONDO**



NEW	COD.	A	B	C	D	Kg
	NBF1121875IS	1"1/2	1.875"	0.500"	0.093"	0,15
	NBF2002500IS	2"	2.500"	0.500"	0.125"	0,26
	NBF2122963IS	2"1/2	2.963"	0.500"	0.125"	0,38
	NBF3003543IS	3"	3.543"	0.590"	0.125"	0,65
	NBF3123937IS	3"1/2	3.937"	0.690"	0.125"	0,99
	NBF4004500IS	4"	4.500"	0.750"	0.125"	1,41
	NBF5005709IS	5"	5.709"	0.880"	0.125"	2,65
	NBF6006750IS	6"	6.750"	1.000"	0.125"	4,30

**Materiale di produzione :** Acciaio 11SMn30 - C45  
**Production material :** Steel 11SMn30 - 080M46  
**Werkstoff :** Stahl 11SMn30 - CK45  
**Matériel de production :** Acier 11SMn30 - C45  
**Material de fabricación :** Acero 11SMn30 - C45

**Materiale di produzione :** Acciaio S355JR - ASTM A105  
**Production material :** Steel S355JR - ASTM A105  
**Werkstoff :** Stahl S355JR - ASTM A105  
**Matériel de production :** Acier S355JR - ASTM A105  
**Material de fabricación :** Acero S355JR - ASTM A105