

Electric Lifting Winches

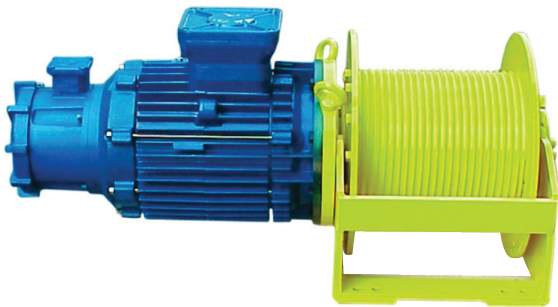

- Grooved Drums
- Wire ropes, Pulley Blocks and hooks
- Stainless Steel Press-cable rollers
- Empty Drum sensor
- Marine Surface treatment
- Load limit systems
- ATEX suitable
- Various Motor / gearbox combinations
- Multiple Drum sizes available
- Class Approvals
- Cable spooling / Level winding mechanisms

Generally self braking motors are used, with optional manual brake release study if required. Ventilated motors are used in conjunction with inverter controls. Marine motor protections as well as our special surface coating and protections for marine applications are fully implemented throughout the series.

Winch range	Winch model	Line pull 1st Layer kg	Drum Diameter mm	Cable Diameter mm	Drum capacity m	Line Speed m/min	Power KW
WE	0,5	1500	218	10	50	10	3
WE	1	2300	322	12	130	10	4
WE	2	4000	322	14	145	10	7,5
WE	3	4800	366	16	150	10	9
WE	4	6000	405	18	120	10	11
WE	5	7000	418	19	170	11	15
WE	6	8000	455	20	185	12	18
WE	7	11000	505	24	160	10	22

Nominal values. Precise proposals on request

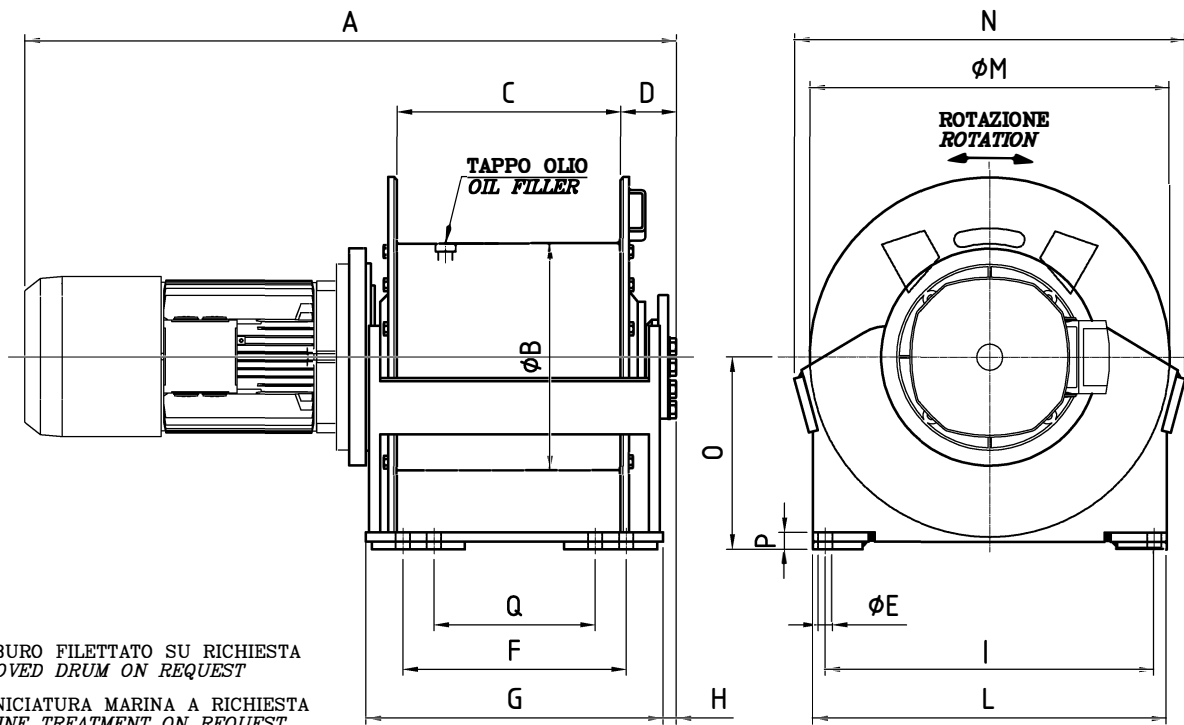

TAMBURO FILETTATO SU RICHIESTA
 GROOVED DRUM ON REQUEST
 VERNICIATURA MARINA A RICHIESTA
 MARINE TREATMENT ON REQUEST

DIMENSIONI - DIMENSIONS (mm)

MODELLO MODEL	A	B	C	D	E	F	G	H	I	L	M	N	O	P	Q
W 0 E	705	218	222	50	13	230	302	10	260	304	318	358	175	20	/
W 1 E	878	298	293	74	19	290	396	17	430	470	450	508	250	24	/
W 2 E	979	322	345	64	19	350	452	18	460	500	510	555	275	24	/
W 3 E	1050	366	360	90	23	360	479	21	530	570	580	630	310	27	260
W 4 E	1082	405	378	96	23	380	506	21	550	610	610	666	335	27	280
W 5 E	1176	418	430	98	23	435	561	22	590	640	660	719	345	32	335
W 6 E	1278	455	444	110	23	470	596	26	670	720	750	788	385	32	370
W 7 E	1417	505	530	119	23	560	699	23	720	790	800	848	411	32	460

DATI TECNICI SECONDO UNI ISO 4301/1
 SECONDO FEM 1.001/1987

TECHNICAL DATA ACCORDING UNI ISO 4301/1
 ACCORDING FEM 1.001/1987

MODELLO MODEL	TIRO 1° STRATO 1st LAYER PULL	TIRO ULTIMO STRATO LAST LAYER PULL	POTENZA MOTORE MOTOR POWER	STRATI FUNE ROPE LAYERS	DIAM. FUNE CONSIGLIATO SUGGESTED ROPE SIZE	QUANTITA' FUNE ROPE CAPACITY	VELOCITA' FUNE 1° STRATO ROPE SPEED 1st LAYER	PESO WEIGHT
	daN	daN	kW	n°	mm	m	m/min	kg
W 0 E	1000	820	1.5	4	8	84	7.5	104
W 1 E	2300	1750	4	5	12	132	9.0	230
W 2 E	2970	2230	5.5	5	14	145	10.0	300
W 3 E	4000	3040	7.5	5	15	145	8.5	380
W 4 E	5300	4060	9.2	5	16	172	9.0	460
W 5 E	6000	4510	11	5	18	182	8.0	480
W 6 E	8000	5890	15	5	20	185	10.0	760
W 7 E	10000	7860	18.5	4	24	159	9.5	800