

PVSM



Screw to connect couplings for high pressure, ISO 14540 interchange, ball valve.

PVSM screw-to-connect couplings have been purposely designed for the heaviest applications in terms of working pressure. Equipped with a metal-to-metal sealing ball valve they are interchangeable according to ISO 14540 standards.



Applications

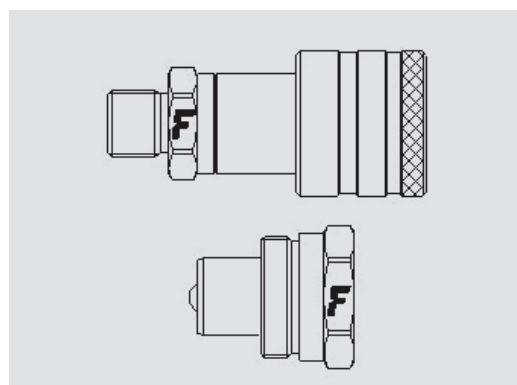

Technical Specifications

dash	Size mm	inch	Working Pressure (MPa)	Flow Rate (l/min)	Spillage (ml)	Force to Connect (N)	Burst pressure (MPa)		
							Male	Female	Male + Female
06	10	3/8"	72	14	1	0	144	180	260

Material	Steel
Seals	NBR
Working temperatures	- 25 °C to + 125 °C
Surface treatment	MATE 500 (CrIII)
Series Interchange	ISO 14540
Valve Type	Ball
Connection	Screw to Connect
Disconnection	Unscrew to Disconnect
Connection Under Pressure	Allowed Residual

Pressure Drop

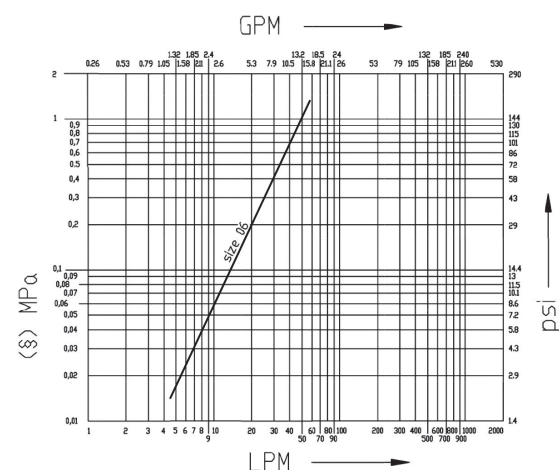

PVSM

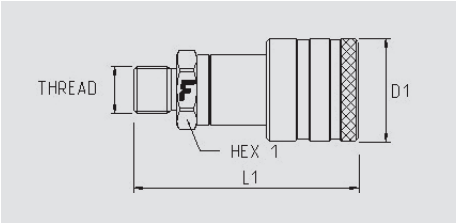

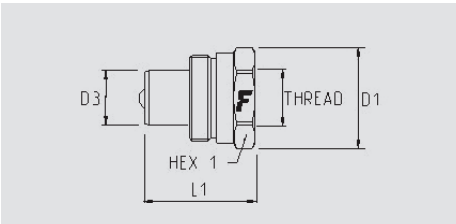

Size		Thread details			FEMALE						
inch	mm	Thread Type	Standard	Thread	Part Number	L (L1 + Thread)		D1		HEX1	
						mm	inch	mm	inch	mm	inch
3/8'	10	01/ NPTF	ANSI B1.20.3	NPTF 3/8 MALE	PVSM1/38NPT F	77,5	3,1	36,0	1,4		



Size		Thread details			MALE						
inch	mm	Thread Type	Standard	Thread	Part Number	L (L1 + Thread)		D1		D3	
						mm	inch	mm	inch	mm	inch
3/8'	10	F NPTF	ANSI B1.20.3	NPTF 3/8 FEMALE	PVSM 38 NPT M	39,0	1,5	35,5	1,4	19,0	0,7
										32,0	1,3

Aluminium dust caps

									
Plugs suitable for FEMALE					Caps suitable for MALE				
Size			Plug Details		Size			Cap Details	
inch	mm	dash	Part number	Colour	inch	mm	dash	Part number	Colour
3/8"	10	06	TMP 38		3/8"	10	06	TFP 38	

Seal Kits

	Size			For Female	
				Seal Details	
	inch	mm	dash	Material	Part Number
	3/8"	10	06	NBR; PTFE	SK PVVM 38

Every seals kit is composed of 5 or 10 pcs.

